

# Open Gate Ranch

## 42<sup>nd</sup> Annual Bull Sale



**Thursday, March 31, 2022**

**1:00 pm • Simms, MT**

At Broken O Land and Livestock

**Simmental. SimAngus. BUILD BETTER BEEF.**

# Notes on Reading our Sale Book...



When we sort through the stacks of Bull Sale Books we receive each year, we notice everyone presents their data a bit differently. Surely, this can get confusing-but it's important to remember there is no right or wrong formula to building a catalog. We choose to present the data that is most relevant to the way we make breeding decisions, the way we manage our cattle, and the trends we want to be able to track and observe in each year's calf crop.

For example, we like to think of our cattle in simple, straightforward terms, that we can actually keep straight mentally and visualize. So we don't include as many EPDs as we could. We monitor our trends on all of the traits and understand their merit, but we strive to effect change according to what most of our customers need. So a simpler data set works well for us. We continue to provide actual records of ultrasound, gain, and birthweight, because we like to see whether traits are truly manifesting themselves - if the patterns in a sire group show that genetic markers have actually triggered and are doing what they promise. Large discrepancies or inconsistencies in a sire group are a red flag to us and will influence our decision of whether to use a sire again.

So please don't hesitate to reach out to one of us if you do not see data you need, or if it is unclear why we include it. We would love to help you utilize better the patterns we see when we put it together every year.

## Sale Location

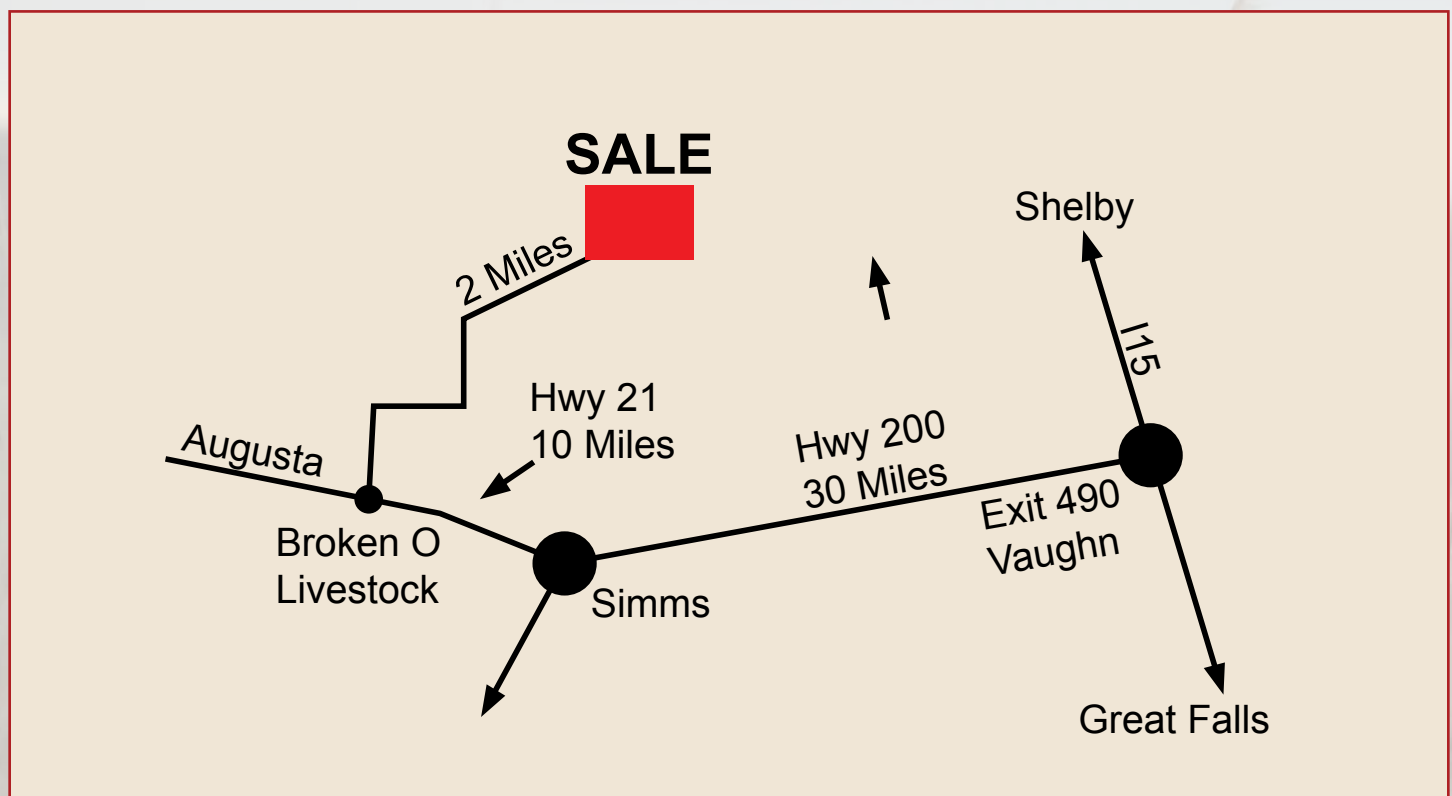

# Open Gate Ranch

Thursday, March 31, 2022

1:00 pm • Simms, MT

At Broken O Land and Livestock

## SCHEDULE OF EVENTS

### THURSDAY, MARCH 31

All Day Cattle available for viewing  
*Come early for coffee and to see the bulls.*

12:00 NOON Lunch

1:00 PM **OPEN GATE RANCH BULL SALE**

## SALE LOCATION

Broken O Land and Livestock is located ten miles west of Simms, MT on Highway 21. For map and directions, see opposite page.

## AUCTIONEER

Roger Jacobs

## LIVESTOCK PRESS REPRESENTATIVES

John Goggins, *Western Ag Reporter*

Jeff Thomas, *Lee Agri Media*

Devin Murnin, *Western Livestock Journal*

## SEMEN INTEREST

Open Gate Ranch reserves the right to collect semen for our personal use on any of the bulls offered in the sale. This will be done outside the breeding season at our expense.

## SATISFACTION GUARANTEED

Open Gate Ranch offers a **complete satisfaction and soundness guarantee** up to the second breeding season on every bull purchased at our sale. This includes bull replacement or full credit minus salvage against a new one. Please notify one of us immediately if any problem develops. We truly want to be the first to know.

Any individual purchasing **3 or more bulls will receive a 5% volume discount** off the purchase price.

There is **\$100 discount per bull for hauling** your own on sale day.

Buyers unable to attend the sale can **purchase bulls sight unseen** and know that when we deliver them - if you don't like them, you don't own them. Please contact us ahead of time if you would like to bid by proxy or by phone.

SALE DAY PHONE 406-264-5926

### FAMILY PHONES:

Mike and Kim 467-2082 • Julie 590-4063 • Micah 590-1609  
Dustin 590-6016

[www.OPENGATERANCH.COM](http://www.OPENGATERANCH.COM)

## ABOUT THE BULLS

The bulls are available for viewing at the ranch prior to the sale. They are located in the development pasture near the ranch. From Fairfield, take Hwy 408 west for 9.5 miles, turn north onto the gravel, top the big hill, 3/4 of a mile further the and the bulls are on the right.

Videos of the bulls available online [www.opengateranch.com](http://www.opengateranch.com)

**EPDs** on both sale bulls and Reference Sires are printed as calculated by American Simmental Association and follow the Simmental definition for each trait.

**Ultrasound scan data** was taken on 2/18/2022 by Sonya Gregory and interpreted at a Central Ultrasound Processing Lab. It is an actual calculation of each bull's carcass information that has been adjusted to a 365 day measurement, which will facilitate accurate comparison between bulls. American Simmental Association provided updated Carcass EPDs based on the scan data. IMF is marbling as a percent of mass, BF is back fat in percent of inch, and REA is rib eye in square inches. Ultrasound data available sale day.

**Scrotal evaluation and fertility testing** was done by Dr. Cale Bjornstad on 2/25/2022.

**ALLIED**  
GENETIC RESOURCES

Marty Ropp 406-581-7835  
Rocky Forseth 406-590-7984  
[www.alliedgeneticresources.com](http://www.alliedgeneticresources.com)

# WELCOME TO THE SALE



**W**hen confronted with a challenge, it's good to remember how you have overcome them before.

*Stick* with what *works*.

And boy, don't the challenges just keep coming. But we could sit around and list challenges all day and never find the end of them. What matters more is how we engage with our current realities and what we plan to do with tomorrow.

There's a reason they call this "next year country".

We find ourselves returning to the foundation basics of what has helped us navigate tough times before. Remain focused on gratitude. Family and friends that stick by you through every grueling weather event or unexpected wrench in the gears are a goldmine.

- Take pride in the progress you've made in building a herd of cattle that earn your living and make you happy.
- Savor that first cup of coffee, and the landscape shot through with all the ecstatic colors of dawn.
- Remember the days are getting longer.
- Laugh at yourself when you screw up. Then fix it.
- Tell your people that you love them. As often as you can . . .

It is in just such a spirit of gratitude, that we invite you to our 42<sup>nd</sup> Annual Sale and a day of memorable, Western hospitality.

As for the nuts and bolts of remaining profitable, we are presenting you with a genetic offering that represents the very core of what Open Gate believes in. Maternal excellence, quiet dispositions, early gain, and harnessing the powerful, irreplaceable advantages of crossbreeding. These cattle are rugged, with well grown frames. We focus on robust rumen development so they will transfer seamlessly into your feeding program. The heifers went straight to grass stubble after weaning and wintered on long stem hay. It's simple. It works. We're sticking with it.

Please accept our warmest greetings as we transition into Spring,  
*The Open Gate Crew*

# WS PROCLAMATION E202

A purebred Simmental on the path of a meteoric career in what the breed does best: tremendous performance, rib, hip and foundation to keep yield high without sacrificing maternal advantages or sensible calving ease. Build some enormously profitable cows with this set of Bulls.



WS PROCLAMATION E202 Reference Sire.

## WS PROCLAMATION E202

**PB SM** Bull ASA #3254156

SIRE: CCR COWBOY CUT 5048Z

MGS: CLRS GRADE-A 875 A

| CE   | BW  | WW    | YW    | MCE | MILK | MWW  | MARB | REA  | \$API | \$TI  |
|------|-----|-------|-------|-----|------|------|------|------|-------|-------|
| 12.5 | 0.5 | 100.6 | 149.2 | 8.1 | 38.9 | 89.1 | 0.6  | 0.88 | 171.5 | 106.4 |

# Bulls to sire OPTIMISM!

## 1 JF998 3/4 SM

**Black** Polled  
Bull ASA #3902626 JF998 BD: 1/23/2021

CCR COWBOY CUT 5048Z OGRDX203

WS PROCLAMATION E202 F998

WS MISS SUGAR C4 OGRA820

365 Day Ultrasound

| BW | 10/14 WW | SALE WT | SC   | ADG  | WDA  | IMF  | BF   | REA   |
|----|----------|---------|------|------|------|------|------|-------|
| 98 | 1054     | 1579    | 40.0 | 4.10 | 3.48 | 1.96 | 0.10 | 13.68 |

| CE  | BW  | WW    | YW    | MCE | MILK | MWW  | MB   | REA  | API   | TI   |
|-----|-----|-------|-------|-----|------|------|------|------|-------|------|
| 9.2 | 3.3 | 110.9 | 162.1 | 6.2 | 37.4 | 92.8 | 0.35 | 0.91 | 139.4 | 97.6 |



JF998 Sells as Lot 1.

## 2 JF723 PB SM

**Black** Polled  
Bull ASA #4007959 JF723 BD: 2/6/2021

CCR COWBOY CUT 5048Z OLF OTIS Y43

WS PROCLAMATION E202 OGRF723

WS MISS SUGAR C4 OGRD199

365 Day Ultrasound

| BW | 10/14 WW | SALE WT | SC   | ADG  | WDA  | IMF  | BF   | REA   |
|----|----------|---------|------|------|------|------|------|-------|
| 90 | 966      | 1651    | 40.0 | 3.37 | 3.77 | 3.33 | 0.22 | 13.31 |

| CE   | BW  | WW    | YW    | MCE | MILK | MWW  | MB   | REA  | API   | TI    |
|------|-----|-------|-------|-----|------|------|------|------|-------|-------|
| 12.4 | 1.6 | 108.7 | 173.1 | 8.5 | 37.9 | 92.2 | 0.37 | 0.92 | 163.2 | 104.8 |





JB443 Sells as Lot 3.

**3 JB443 3/4 SM**

**Black Polled**  
**Bull ASA #4007866 JB443 BD: 1/29/2021**

CCR COWBOY CUT 5048Z W H S LIMELIGHT 64V  
 WS PROCLAMATION E202 TAYLORB443  
 WS MISS SUGAR C4 TAYLORZ382

| 365 Day Ultrasound |          |         |       |      |      |      |      |       |       |      |
|--------------------|----------|---------|-------|------|------|------|------|-------|-------|------|
| BW                 | 10/14 WW | SALE WT | SC    | ADG  | WDA  | IMF  | BF   | REA   |       |      |
| 98                 | 1040     | 1510    | 40.0  | 3.96 | 3.36 | 2.23 | 0.14 | 14.08 |       |      |
| CE                 | BW       | WW      | YW    | MCE  | MILK | MWW  | MB   | REA   | API   | TI   |
| 12.2               | 1.1      | 92.2    | 137.1 | 8.2  | 33.1 | 79.1 | 0.51 | 0.88  | 149.5 | 93.3 |

**4 JE569 3/4 SM**

**Black Polled**  
**Bull ASA #4007850 JE569 BD: 1/29/2021**

CCR COWBOY CUT 5048Z OGRZT016  
 WS PROCLAMATION E202 E569  
 WS MISS SUGAR C4 SVR U019

| 365 Day Ultrasound |          |         |       |      |      |      |      |       |       |      |
|--------------------|----------|---------|-------|------|------|------|------|-------|-------|------|
| BW                 | 10/14 WW | SALE WT | SC    | ADG  | WDA  | IMF  | BF   | REA   |       |      |
| 84                 | 952      | 1421    | 39.5  | 3.56 | 3.16 | 3.18 | 0.21 | 12.18 |       |      |
| CE                 | BW       | WW      | YW    | MCE  | MILK | MWW  | MB   | REA   | API   | TI   |
| 13.8               | -1.0     | 83.3    | 122.9 | 8.0  | 30.7 | 72.3 | 0.50 | 0.63  | 150.6 | 89.4 |

**5 JG282 3/4 SM**

**Black Polled**  
**Bull ASA #4007965 JG282 BD: 1/19/2021**

CCR COWBOY CUT 5048Z CONNEALY SPUR  
 WS PROCLAMATION E202 G282  
 WS MISS SUGAR C4 SVRW600

| 365 Day Ultrasound |          |         |       |      |      |      |      |       |       |      |
|--------------------|----------|---------|-------|------|------|------|------|-------|-------|------|
| BW                 | 10/14 WW | SALE WT | SC    | ADG  | WDA  | IMF  | BF   | REA   |       |      |
| 86                 | 912      | 1402    | 42.0  | 3.58 | 3.04 | 2.85 | 0.28 | 14.02 |       |      |
| CE                 | BW       | WW      | YW    | MCE  | MILK | MWW  | MB   | REA   | API   | TI   |
| 11.1               | 1.4      | 92.5    | 137.4 | 7.7  | 32.0 | 78.2 | 0.51 | 0.81  | 150.9 | 92.4 |

**6 JG127 7/8 SM**

**Black Polled**  
**Bull ASA #4007763 JG127 BD: 1/23/2021**

CCR COWBOY CUT 5048Z OLF OTIS Y43  
 WS PROCLAMATION E202 G127  
 WS MISS SUGAR C4 OGRE439

| 365 Day Ultrasound |          |         |       |      |      |      |      |       |       |       |
|--------------------|----------|---------|-------|------|------|------|------|-------|-------|-------|
| BW                 | 10/14 WW | SALE WT | SC    | ADG  | WDA  | IMF  | BF   | REA   |       |       |
| 87                 | 898      | 1507    | 34.0  | 4.00 | 3.31 | 2.71 | 0.15 | 13.58 |       |       |
| CE                 | BW       | WW      | YW    | MCE  | MILK | MWW  | MB   | REA   | API   | TI    |
| 13.3               | 1.1      | 103.5   | 161.6 | 9.0  | 32.9 | 84.6 | 0.30 | 0.94  | 157.8 | 100.2 |

**7 JF981 7/8 SM**

**Black Polled**  
**Bull ASA #3902620 JF981 BD: 1/23/2021**

CCR COWBOY CUT 5048Z OGRDX203  
 WS PROCLAMATION E202 F981  
 WS MISS SUGAR C4 OGRY996

| 365 Day Ultrasound |          |         |       |      |      |      |      |       |       |      |
|--------------------|----------|---------|-------|------|------|------|------|-------|-------|------|
| BW                 | 10/14 WW | SALE WT | SC    | ADG  | WDA  | IMF  | BF   | REA   |       |      |
| 98                 | 862      | 1480    | 40.0  | 3.49 | 3.25 | 2.46 | 0.17 | 14.58 |       |      |
| CE                 | BW       | WW      | YW    | MCE  | MILK | MWW  | MB   | REA   | API   | TI   |
| 8.7                | 3.4      | 99.8    | 155.0 | 6.4  | 32.9 | 82.8 | 0.37 | 0.94  | 134.4 | 91.3 |



JF740 Sells as Lot 8.

**8 JF740 3/4 SM**

**Black Polled**  
**Bull ASA #4007819 JF740 BD: 2/5/2021**

CCR COWBOY CUT 5048Z HOOK'S EASTWOOD 30C  
 WS PROCLAMATION E202 OGRF740  
 WS MISS SUGAR C4 OGRC870

| 365 Day Ultrasound |          |         |       |      |      |      |      |       |       |      |
|--------------------|----------|---------|-------|------|------|------|------|-------|-------|------|
| BW                 | 10/14 WW | SALE WT | SC    | ADG  | WDA  | IMF  | BF   | REA   |       |      |
| 90                 | 864      | 1330    | 39.0  | 3.56 | 2.99 | 2.31 | 0.23 | 14.99 |       |      |
| CE                 | BW       | WW      | YW    | MCE  | MILK | MWW  | MB   | REA   | API   | TI   |
| 11.9               | 0.8      | 90.8    | 132.2 | 7.0  | 31.3 | 76.6 | 0.37 | 0.95  | 139.1 | 89.0 |

# 9 JG218 3/4 SM

Black Polled  
Bull ASA #4007963 JG218 BD: 1/23/2021

CCR COWBOY CUT 5048Z GIBBS 0601X RAISINCAIN  
WS PROCLAMATION E202 G218  
WS MISS SUGAR C4 OGRA546

365 Day Ultrasound

| BW   | 10/14 WW | SALE WT | SC    | ADG  | WDA  | IMF  | BF   | REA   |       |      |
|------|----------|---------|-------|------|------|------|------|-------|-------|------|
| 86   | 816      | 1308    | 37.5  | 3.44 | 2.85 | 3.73 | 0.19 | 11.68 |       |      |
| CE   | BW       | WW      | YW    | MCE  | MILK | MWW  | MB   | REA   | API   | TI   |
| 11.4 | 0.7      | 85.4    | 126.9 | 7.2  | 32.9 | 75.6 | 0.48 | 0.67  | 143.7 | 88.7 |

# 10 JB677 3/4 SM

Black Polled  
Bull ASA #4007938 JB677 BD: 3/5/2021

CCR COWBOY CUT 5048Z OGRZU171  
WS PROCLAMATION E202 OGRB677  
WS MISS SUGAR C4 OGR712

365 Day Ultrasound

| BW   | 10/14 WW | SALE WT | SC    | ADG  | WDA  | IMF  | BF   | REA   |       |      |
|------|----------|---------|-------|------|------|------|------|-------|-------|------|
| 90   | 832      | 1292    | 38.5  | 3.70 | 3.11 | 2.66 | 0.17 | 12.54 |       |      |
| CE   | BW       | WW      | YW    | MCE  | MILK | MWW  | MB   | REA   | API   | TI   |
| 11.2 | 0.7      | 82.8    | 124.5 | 6.9  | 31.7 | 73.0 | 0.50 | 0.69  | 142.3 | 87.5 |

# 11 JG196 3/4 SM

Black Polled  
Bull ASA #4007962 JG196 BD: 1/16/2021

CCR COWBOY CUT 5048Z V A R LEGEND 5019  
WS PROCLAMATION E202 G196  
WS MISS SUGAR C4 SVRX693

365 Day Ultrasound

| BW   | 10/14 WW | SALE WT | SC    | ADG  | WDA  | IMF  | BF   | REA   |       |      |
|------|----------|---------|-------|------|------|------|------|-------|-------|------|
| 86   | 872      | 1357    | 38.0  | 3.21 | 2.91 | 3.16 | 0.17 | 12.17 |       |      |
| CE   | BW       | WW      | YW    | MCE  | MILK | MWW  | MB   | REA   | API   | TI   |
| 12.4 | 0.5      | 86.3    | 139.1 | 8.5  | 28.0 | 71.1 | 0.53 | 0.72  | 152.5 | 90.7 |

# 12 JF738 PB SM

Black Polled  
Bull ASA #4007960 JF738 BD: 2/3/2021

CCR COWBOY CUT 5048Z OLF OTIS Y43  
WS PROCLAMATION E202 OGRF738  
WS MISS SUGAR C4 OGRC992

365 Day Ultrasound

| BW   | 10/14 WW | SALE WT | SC    | ADG  | WDA  | IMF  | BF   | REA   |       |      |
|------|----------|---------|-------|------|------|------|------|-------|-------|------|
| 80   | 774      | 1260    | 36.0  | 3.06 | 2.81 | 2.03 | 0.11 | 13.56 |       |      |
| CE   | BW       | WW      | YW    | MCE  | MILK | MWW  | MB   | REA   | API   | TI   |
| 14.6 | -0.4     | 85.0    | 127.6 | 9.9  | 29.9 | 72.4 | 0.24 | 0.85  | 153.0 | 89.2 |

# 13 JF101 3/4 SM

Black Polled  
Bull ASA #4007958 JF101 BD: 1/26/2021

CCR COWBOY CUT 5048Z OGRDX203  
WS PROCLAMATION E202 F101  
WS MISS SUGAR C4 OGRD207

365 Day Ultrasound

| BW   | 10/14 WW | SALE WT | SC    | ADG  | WDA  | IMF  | BF   | REA   |       |      |
|------|----------|---------|-------|------|------|------|------|-------|-------|------|
| 94   | 892      | 1387    | 36.0  | 3.37 | 3.05 | 2.87 | 0.24 | 13.33 |       |      |
| CE   | BW       | WW      | YW    | MCE  | MILK | MWW  | MB   | REA   | API   | TI   |
| 10.4 | 2.5      | 100.2   | 149.5 | 7.3  | 33.4 | 83.5 | 0.38 | 0.88  | 141.4 | 92.8 |



JF101 Sells as Lot 13.

# 14 JG146 1/2 SM

Black Polled  
Bull ASA #4007961 JG146 BD: 1/16/2021

CCR COWBOY CUT 5048Z HOOK'S CAPITALIST 37C  
WS PROCLAMATION E202 G146  
WS MISS SUGAR C4 OGRC842

365 Day Ultrasound

| BW   | 10/14 WW | SALE WT | SC    | ADG  | WDA  | IMF  | BF   | REA   |       |      |
|------|----------|---------|-------|------|------|------|------|-------|-------|------|
| 85   | 896      | 1395    | 37.0  | 3.63 | 3.00 | 3.20 | 0.15 | 10.77 |       |      |
| CE   | BW       | WW      | YW    | MCE  | MILK | MWW  | MB   | REA   | API   | TI   |
| 13.3 | -0.2     | 87.5    | 131.5 | 7.9  | 32.2 | 75.9 | 0.56 | 0.58  | 154.2 | 92.9 |



# CDI TRUSTEE 387F

Wide and deep and powerful, he swings back toward the foundation of Simmental performance, exceptional maternal qualities and wonderful docility. Both sons and daughters are quiet and steady. Muscle in all the right places.



CDI TRUSTEE 387F Reference Sire.

## CDI TRUSTEE 387F

**PB SM** Bull ASA #3429754

SIRE: CDI REVIVAL 370D

MGS: CDI HOMETOWN 246A

| CE  | BW  | WW   | YW    | MCE | MILK | MWW  | MARB | REA  | \$API | \$TI |
|-----|-----|------|-------|-----|------|------|------|------|-------|------|
| 9.8 | 2.6 | 98.3 | 152.4 | 4.4 | 21.3 | 70.4 | 0.18 | 1.52 | 139.3 | 91.8 |

# Bulls to sire OPTIMISM!



## 16 JC952 3/4 SM

Black Polled  
Bull ASA #4011944 JC952

BD: 2/28/2021

CDI REVIVAL 370D  
CDI TRUSTEE 387F  
CDI MISS HOMETOWN 163C

W/C UNITED 956Y

OGRC952

SVR U295

365 Day Ultrasound

| BW | 10/14 WW | SALE WT | SC   | ADG  | WDA  | IMF  | BF   | REA   |
|----|----------|---------|------|------|------|------|------|-------|
| 90 | 871      | 1471    | 37.0 | 3.82 | 3.52 | 1.93 | 0.11 | 16.36 |

| CE  | BW  | WW   | YW    | MCE | MILK | MWW  | MB   | REA  | API   | TI   |
|-----|-----|------|-------|-----|------|------|------|------|-------|------|
| 9.9 | 2.1 | 95.7 | 157.4 | 5.6 | 20.9 | 68.7 | 0.14 | 1.27 | 125.7 | 85.0 |



## 17 JZ370 5/8 SM

Black Polled  
Bull ASA #4012178 JZ370

BD: 2/21/2021

CDI REVIVAL 370D  
CDI TRUSTEE 387F  
CDI MISS HOMETOWN 163C

GARDENS WAVE

OGRZ370

OGRX273

365 Day Ultrasound

| BW | 10/14 WW | SALE WT | SC   | ADG  | WDA  | IMF  | BF   | REA   |
|----|----------|---------|------|------|------|------|------|-------|
| 90 | 886      | 1418    | 34.0 | 3.76 | 3.33 | 2.86 | 0.13 | 16.45 |

| CE   | BW  | WW   | YW    | MCE | MILK | MWW  | MB   | REA  | API   | TI   |
|------|-----|------|-------|-----|------|------|------|------|-------|------|
| 11.7 | 0.7 | 81.8 | 127.0 | 6.3 | 22.3 | 63.1 | 0.40 | 1.07 | 133.6 | 82.7 |

JZ370 Sells as Lot 17.



# 18 JC968 1/2 SM

**Black Polled**  
**Bull ASA #4012179 JC968 BD: 2/23/2021**

CDI REVIVAL 370D W/C UNITED 956Y  
 CDI TRUSTEE 387F OGR968  
 CDI MISS HOMETOWN 163C OGRY303

365 Day Ultrasound

| BW   | 10/14 WW | SALE WT | SC    | ADG  | WDA  | IMF  | BF   | REA   |       |      |
|------|----------|---------|-------|------|------|------|------|-------|-------|------|
| 90   | 910      | 1424    | 38.0  | 3.68 | 3.36 | 2.66 | 0.15 | 15.68 |       |      |
| CE   | BW       | WW      | YW    | MCE  | MILK | MWW  | MB   | REA   | API   | TI   |
| 10.4 | 1.9      | 92.8    | 145.4 | 5.7  | 24.9 | 71.3 | 0.20 | 1.15  | 127.1 | 84.9 |



JC968 Sells as Lot 18.

# 19 JD253 3/4 SM

**Black Polled**  
**Bull ASA #4007729 JD253 BD: 2/16/2021**

CDI REVIVAL 370D TSN PROTEGE Z896  
 CDI TRUSTEE 387F OGRD253  
 CDI MISS HOMETOWN 163C OGRX728

365 Day Ultrasound

| BW  | 10/14 WW | SALE WT | SC    | ADG  | WDA  | IMF  | BF   | REA   |       |      |
|-----|----------|---------|-------|------|------|------|------|-------|-------|------|
| 95  | 938      | 1561    | 37.0  | 3.91 | 3.64 | 2.80 | 0.18 | 15.17 |       |      |
| CE  | BW       | WW      | YW    | MCE  | MILK | MWW  | MB   | REA   | API   | TI   |
| 8.9 | 3.1      | 90.1    | 138.0 | 3.9  | 18.2 | 63.2 | 0.25 | 1.07  | 127.1 | 81.8 |



JD253 Sells as Lot 19.

# 20 JD408 1/2 SM

**Black Polled**  
**Bull ASA #4012160 JD408 BD: 2/21/2021**

CDI REVIVAL 370D GARDENS WAVE  
 CDI TRUSTEE 387F OGRZ408  
 CDI MISS HOMETOWN 163C SPRING VALLEY M580

365 Day Ultrasound

| BW  | 10/14 WW | SALE WT | SC    | ADG  | WDA  | IMF  | BF   | REA   |       |      |
|-----|----------|---------|-------|------|------|------|------|-------|-------|------|
| 96  | 794      | 1288    | 39.0  | 3.44 | 3.01 | 2.71 | 0.18 | 14.35 |       |      |
| CE  | BW       | WW      | YW    | MCE  | MILK | MWW  | MB   | REA   | API   | TI   |
| 9.9 | 1.7      | 77.7    | 118.0 | 5.6  | 20.0 | 58.7 | 0.34 | 1.02  | 127.9 | 78.4 |



# 21 JC932 3/4 SM

**Black Polled**  
**Bull ASA #4007941 JC932 BD: 2/21/2021**

CDI REVIVAL 370D OGRZT016  
 CDI TRUSTEE 387F OGR932  
 CDI MISS HOMETOWN 163C SVR U119

365 Day Ultrasound

| BW  | 10/14 WW | SALE WT | SC    | ADG  | WDA  | IMF  | BF   | REA   |       |      |
|-----|----------|---------|-------|------|------|------|------|-------|-------|------|
| 98  | 862      | 1429    | 38.0  | 4.10 | 3.36 | 2.56 | 0.15 | 13.75 |       |      |
| CE  | BW       | WW      | YW    | MCE  | MILK | MWW  | MB   | REA   | API   | TI   |
| 9.2 | 2.2      | 89.2    | 140.3 | 5.1  | 22.2 | 66.7 | 0.32 | 1.02  | 134.4 | 84.5 |



JC932 Sells as Lot 21.

OPEN GATE RANCH

**22 JB7831 3/4 SM**

Black Polled  
Bull ASA #4011946 JB7831 BD: 2/22/2021

CDI REVIVAL 370D GW LUCKY MAN 644N  
CDI TRUSTEE 387F OGRB783  
CDI MISS HOMETOWN 163C SVRU029

365 Day Ultrasound

| BW  | 10/14 WW | SALE WT | SC    | ADG  | WDA  | IMF  | BF   | REA   |       |      |
|-----|----------|---------|-------|------|------|------|------|-------|-------|------|
| 81  | 714      | 1309    | 37.0  | 3.87 | 3.06 | 2.44 | 0.13 | 14.06 |       |      |
| CE  | BW       | WW      | YW    | MCE  | MILK | MWW  | MB   | REA   | API   | TI   |
| 9.8 | 2.6      | 88.6    | 138.2 | 4.8  | 21.7 | 66.0 | 0.28 | 0.94  | 129.7 | 83.0 |

**23 JB7832 3/4 SM**

Black Polled  
Bull ASA #4011947 JB7832 BD: 2/22/2021

CDI REVIVAL 370D GW LUCKY MAN 644N  
CDI TRUSTEE 387F OGRB783  
CDI MISS HOMETOWN 163C SVRU029

365 Day Ultrasound

| BW  | 10/14 WW | SALE WT | SC    | ADG  | WDA  | IMF  | BF   | REA   |       |      |
|-----|----------|---------|-------|------|------|------|------|-------|-------|------|
| 82  | 666      | 1300    | 36.0  | 2.86 | 3.04 | 1.97 | 0.15 | 12.46 |       |      |
| CE  | BW       | WW      | YW    | MCE  | MILK | MWW  | MB   | REA   | API   | TI   |
| 9.8 | 2.6      | 88.6    | 138.2 | 4.8  | 21.7 | 66.0 | 0.28 | 0.94  | 129.7 | 83.0 |

**24 JC870 3/4 SM**

Black Polled  
Bull ASA #4007940 JC870 BD: 2/21/2021

CDI REVIVAL 370D GW PREMIUM BEEF 021TS  
CDI TRUSTEE 387F OGRC870  
CDI MISS HOMETOWN 163C OGRA550

365 Day Ultrasound

| BW   | 10/14 WW | SALE WT | SC    | ADG  | WDA  | IMF  | BF   | REA   |       |      |
|------|----------|---------|-------|------|------|------|------|-------|-------|------|
| 90   | 866      | 1362    | 35.0  | 3.65 | 3.19 | 2.18 | 0.18 | 13.95 |       |      |
| CE   | BW       | WW      | YW    | MCE  | MILK | MWW  | MB   | REA   | API   | TI   |
| 10.7 | 1.5      | 85.9    | 132.0 | 5.0  | 23.5 | 66.4 | 0.26 | 1.09  | 131.7 | 82.5 |

**25 JZ358 3/4 SM**

Black Polled  
Bull ASA #4007969 JZ358 BD: 2/20/2021

CDI REVIVAL 370D GW PREDESTINED 701T  
CDI TRUSTEE 387F SVRZ358  
CDI MISS HOMETOWN 163C SVRX298

365 Day Ultrasound

| BW   | 10/14 WW | SALE WT | SC    | ADG  | WDA  | IMF  | BF   | REA   |       |      |
|------|----------|---------|-------|------|------|------|------|-------|-------|------|
| 86   | 820      | 1312    | 39.0  | 3.62 | 3.06 | 2.09 | 0.19 | 15.73 |       |      |
| CE   | BW       | WW      | YW    | MCE  | MILK | MWW  | MB   | REA   | API   | TI   |
| 12.3 | 0.0      | 81.4    | 124.2 | 6.5  | 18.9 | 59.6 | 0.32 | 1.11  | 141.3 | 83.1 |

**26 JX741 PB SM**

Black Polled  
Bull ASA #4012177 JX741 BD: 3/9/2021

CDI REVIVAL 370D JF SHOCK AND AWE 620TS  
CDI TRUSTEE 387F OGRX741  
CDI MISS HOMETOWN 163C OGRH267

365 Day Ultrasound

| BW  | 10/14 WW | SALE WT | SC    | ADG  | WDA  | IMF  | BF   | REA   |       |      |
|-----|----------|---------|-------|------|------|------|------|-------|-------|------|
| 98  | 962      | 1486    | 41.5  | 3.55 | 3.64 | 4.24 | 0.21 | 12.71 |       |      |
| CE  | BW       | WW      | YW    | MCE  | MILK | MWW  | MB   | REA   | API   | TI   |
| 9.9 | 2.4      | 78.1    | 116.3 | 4.8  | 22.5 | 61.5 | 0.30 | 1.12  | 121.5 | 77.6 |

**27 JA289 7/8 SM**

Black Polled  
Bull ASA #4007926 JA289 BD: 2/23/2021

CDI REVIVAL 370D SVRW909  
CDI TRUSTEE 387F OGRA289  
CDI MISS HOMETOWN 163C OGR703

365 Day Ultrasound

| BW  | 10/14 WW | SALE WT | SC    | ADG  | WDA  | IMF  | BF   | REA   |       |      |
|-----|----------|---------|-------|------|------|------|------|-------|-------|------|
| 89  | 806      | 1298    | 38.0  | 3.23 | 3.04 | 2.25 | 0.13 | 14.28 |       |      |
| CE  | BW       | WW      | YW    | MCE  | MILK | MWW  | MB   | REA   | API   | TI   |
| 9.7 | 1.3      | 79.8    | 119.9 | 4.8  | 20.8 | 60.6 | 0.20 | 1.08  | 124.3 | 77.2 |



JB647 Sells as Lot 28.

**28 JB647 5/8 SM**

Black Polled  
Bull ASA #4007936 JB647 BD: 3/6/2021

CDI REVIVAL 370D BALDRIDGE WAYLON W34  
CDI TRUSTEE 387F OGRB647  
CDI MISS HOMETOWN 163C OGRW851

365 Day Ultrasound

| BW  | 10/14 WW | SALE WT | SC    | ADG  | WDA  | IMF  | BF   | REA   |       |      |
|-----|----------|---------|-------|------|------|------|------|-------|-------|------|
| 90  | 764      | 1451    | 41.0  | 3.70 | 3.52 | 2.68 | 0.14 | 13.86 |       |      |
| CE  | BW       | WW      | YW    | MCE  | MILK | MWW  | MB   | REA   | API   | TI   |
| 9.6 | 2.4      | 90.2    | 149.7 | 5.6  | 17.9 | 62.9 | 0.32 | 0.99  | 128.6 | 83.3 |

# 29 JD239 5/8 SM

Black Polled  
Bull ASA #4007943 JD239 BD: 2/23/2021

CDI REVIVAL 370D W/C UNITED 956Y  
CDI TRUSTEE 387F OGRD239  
CDI MISS HOMETOWN 163C OGRT717

365 Day Ultrasound

| BW  | 10/14 WW | SALE WT | SC    | ADG  | WDA  | IMF  | BF   | REA   |       |      |
|-----|----------|---------|-------|------|------|------|------|-------|-------|------|
| 95  | 764      | 1200    | 34.0  | 3.24 | 2.80 | 1.73 | 0.11 | 13.18 |       |      |
| CE  | BW       | WW      | YW    | MCE  | MILK | MWW  | MB   | REA   | API   | TI   |
| 9.6 | 1.8      | 78.4    | 120.1 | 5.2  | 19.2 | 58.3 | 0.13 | 0.90  | 111.7 | 73.6 |

# 30 JE492 3/4 SM

Red Polled  
Bull ASA #4007952 JE492 BD: 2/17/2021

CDI REVIVAL 370D TJ COWBOY UP 529B  
CDI TRUSTEE 387F OGRE492  
CDI MISS HOMETOWN 163C OGRB672

365 Day Ultrasound

| BW   | 10/14 WW | SALE WT | SC    | ADG  | WDA  | IMF  | BF   | REA   |       |      |
|------|----------|---------|-------|------|------|------|------|-------|-------|------|
| 87   | 854      | 1389    | 37.0  | 2.76 | 3.22 | 3.13 | 0.15 | 11.78 |       |      |
| CE   | BW       | WW      | YW    | MCE  | MILK | MWW  | MB   | REA   | API   | TI   |
| 10.8 | 1.6      | 89.3    | 137.2 | 5.9  | 21.8 | 66.4 | 0.33 | 0.92  | 136.8 | 85.5 |

# 31 JE463 7/8 SM

Black Polled  
Bull ASA #4007948 JE463 BD: 2/11/2021

CDI REVIVAL 370D HOOKS TRINITY 9T  
CDI TRUSTEE 387F OGRE463  
CDI MISS HOMETOWN 163C OGRC844

365 Day Ultrasound

| BW   | 10/14 WW | SALE WT | SC    | ADG  | WDA  | IMF  | BF   | REA   |       |      |
|------|----------|---------|-------|------|------|------|------|-------|-------|------|
| 90   | 894      | 1409    | 37.0  | 3.10 | 3.23 | 2.03 | 0.11 | 13.69 |       |      |
| CE   | BW       | WW      | YW    | MCE  | MILK | MWW  | MB   | REA   | API   | TI   |
| 11.4 | 1.3      | 90.6    | 136.1 | 5.1  | 20.9 | 66.1 | 0.25 | 1.11  | 132.4 | 85.3 |

# 32 JB617 3/4 SM

Black Polled  
Bull ASA #4007934 JB617 BD: 2/23/2021

CDI REVIVAL 370D G A R PROGRESS  
CDI TRUSTEE 387F OGRB617  
CDI MISS HOMETOWN 163C OGRZ013

365 Day Ultrasound

| BW   | 10/14 WW | SALE WT | SC    | ADG  | WDA  | IMF  | BF   | REA   |       |      |
|------|----------|---------|-------|------|------|------|------|-------|-------|------|
| 90   | 900      | 1419    | 39.0  | 3.72 | 3.35 | 3.80 | 0.13 | 12.58 |       |      |
| CE   | BW       | WW      | YW    | MCE  | MILK | MWW  | MB   | REA   | API   | TI   |
| 11.8 | 0.9      | 87.6    | 133.9 | 5.9  | 20.5 | 64.2 | 0.55 | 0.99  | 148.6 | 90.9 |

# 33 JE645 PB SM

Black Polled  
Bull ASA #4007956 JE645 BD: 3/8/2021

CDI REVIVAL 370D HOOK'S BALTIC 17B  
CDI TRUSTEE 387F OGRE645  
CDI MISS HOMETOWN 163C OGRR110

365 Day Ultrasound

| BW  | 10/14 WW | SALE WT | SC    | ADG  | WDA  | IMF  | BF   | REA   |       |      |
|-----|----------|---------|-------|------|------|------|------|-------|-------|------|
| 98  | 762      | 1222    | 37.0  | 3.31 | 2.95 | 1.83 | 0.12 | 14.49 |       |      |
| CE  | BW       | WW      | YW    | MCE  | MILK | MWW  | MB   | REA   | API   | TI   |
| 9.1 | 2.7      | 78.8    | 117.7 | 4.2  | 19.4 | 58.8 | 0.17 | 1.17  | 112.8 | 74.1 |

# 34 JC865 3/4 SM

Black Polled/Scurred  
Bull ASA #4007710 JC865 BD: 2/23/2021

CDI REVIVAL 370D GW PREMIUM BEEF 021TS  
CDI TRUSTEE 387F OGRC865  
CDI MISS HOMETOWN 163C OGRA544

365 Day Ultrasound

| BW   | 10/14 WW | SALE WT | SC    | ADG  | WDA  | IMF  | BF   | REA   |       |      |
|------|----------|---------|-------|------|------|------|------|-------|-------|------|
| 82   | 810      | 1316    | 38.0  | 3.88 | 3.09 | 4.69 | 0.22 | 12.98 |       |      |
| CE   | BW       | WW      | YW    | MCE  | MILK | MWW  | MB   | REA   | API   | TI   |
| 13.2 | 0.0      | 78.1    | 121.3 | 6.6  | 19.8 | 58.8 | 0.38 | 1.05  | 140.9 | 82.8 |

# 35 JA600 3/4 SM

Heterozygous Black Polled  
Bull ASA #4007932 JA600 BD: 2/23/2021

CDI REVIVAL 370D BECKTON EPIC D404  
CDI TRUSTEE 387F OGRA600  
CDI MISS HOMETOWN 163C OGRY626

365 Day Ultrasound

| BW  | 10/14 WW | SALE WT | SC    | ADG  | WDA  | IMF  | BF   | REA   |       |      |
|-----|----------|---------|-------|------|------|------|------|-------|-------|------|
| 98  | 782      | 1307    | 37.0  | 3.66 | 3.07 | 2.89 | 0.15 | 13.18 |       |      |
| CE  | BW       | WW      | YW    | MCE  | MILK | MWW  | MB   | REA   | API   | TI   |
| 9.9 | 1.7      | 75.9    | 118.3 | 5.9  | 18.3 | 56.2 | 0.12 | 0.86  | 118.5 | 71.9 |

# 36 JD3231 7/8 SM

Black Polled  
Bull ASA #4011942 JD3231 BD: 2/20/2021

CDI REVIVAL 370D TNT TANKER U263  
CDI TRUSTEE 387F OGRD323  
CDI MISS HOMETOWN 163C OGRR5992

365 Day Ultrasound

| BW  | 10/14 WW | SALE WT | SC    | ADG  | WDA  | IMF  | BF   | REA   |       |      |
|-----|----------|---------|-------|------|------|------|------|-------|-------|------|
| 89  | 750      | 1279    | 39.5  | 3.21 | 2.98 | 1.67 | 0.08 | 13.63 |       |      |
| CE  | BW       | WW      | YW    | MCE  | MILK | MWW  | MB   | REA   | API   | TI   |
| 8.9 | 2.0      | 85.5    | 128.7 | 5.2  | 20.7 | 63.4 | 0.08 | 1.14  | 118.6 | 76.6 |

**37 JD3232 7/8 SM**

Black Polled  
Bull ASA #4011943 JD3232 BD: 2/20/2021

CDI REVIVAL 370D TNT TANKER U263  
CDI TRUSTEE 387F OGRD323  
CDI MISS HOMETOWN 163C OGR5992

365 Day Ultrasound

| BW  | 10/14 WW | SALE WT | SC    | ADG  | WDA  | IMF  | BF   | REA   |       |      |
|-----|----------|---------|-------|------|------|------|------|-------|-------|------|
| 87  | 765      | 1323    | 38.0  | 3.31 | 3.09 | 1.77 | 0.11 | 14.33 |       |      |
| CE  | BW       | WW      | YW    | MCE  | MILK | MWW  | MB   | REA   | API   | TI   |
| 8.9 | 2.0      | 85.5    | 128.7 | 5.2  | 20.7 | 63.4 | 0.08 | 1.14  | 118.6 | 76.6 |

**38 JD316 PB SM**

Black Polled  
Bull ASA #4007945 JD316 BD: 2/25/2021

CDI REVIVAL 370D LRS UNLIMITED 752A  
CDI TRUSTEE 387F OGRD316  
CDI MISS HOMETOWN 163C SVR 699T

365 Day Ultrasound

| BW   | 10/14 WW | SALE WT | SC    | ADG  | WDA  | IMF  | BF   | REA   |       |      |
|------|----------|---------|-------|------|------|------|------|-------|-------|------|
| 86   | 774      | 1281    | 39.0  | 3.38 | 3.02 | 2.47 | 0.13 | 14.71 |       |      |
| CE   | BW       | WW      | YW    | MCE  | MILK | MWW  | MB   | REA   | API   | TI   |
| 10.0 | 1.4      | 79.2    | 120.0 | 5.1  | 20.0 | 59.5 | 0.15 | 1.34  | 127.3 | 76.2 |

**39 JB611 3/4 SM**

Heterozygous Black Polled  
Bull ASA #4011945 JB611 BD: 2/13/2021

CDI REVIVAL 370D BECKTON EPIC R397 K  
CDI TRUSTEE 387F OGRB611  
CDI MISS HOMETOWN 163C OGRZ992

365 Day Ultrasound

| BW  | 10/14 WW | SALE WT | SC    | ADG  | WDA  | IMF  | BF   | REA   |       |      |
|-----|----------|---------|-------|------|------|------|------|-------|-------|------|
| 75  | 694      | 1142    | 40.0  | 2.90 | 2.59 | 3.13 | 0.13 | 13.52 |       |      |
| CE  | BW       | WW      | YW    | MCE  | MILK | MWW  | MB   | REA   | API   | TI   |
| 9.7 | 1.5      | 83.0    | 127.0 | 5.6  | 23.1 | 64.5 | 0.23 | 0.99  | 127.2 | 79.6 |

**40 JD262 3/4 SM**

Black Polled  
Bull ASA #4007944 JD262 BD: 2/22/2021

CDI REVIVAL 370D TSN PROTEGE Z896  
CDI TRUSTEE 387F OGRD262  
CDI MISS HOMETOWN 163C OGRA385

365 Day Ultrasound

| BW   | 10/14 WW | SALE WT | SC    | ADG  | WDA  | IMF  | BF   | REA   |       |      |
|------|----------|---------|-------|------|------|------|------|-------|-------|------|
| 95   | 752      | 1186    | 38.0  | 2.77 | 2.76 | 2.87 | 0.09 | 12.26 |       |      |
| CE   | BW       | WW      | YW    | MCE  | MILK | MWW  | MB   | REA   | API   | TI   |
| 10.9 | 0.7      | 78.2    | 114.8 | 4.7  | 18.3 | 57.4 | 0.26 | 0.94  | 129.9 | 77.9 |



# Videos of Bull Offering

Please visit our website  
[www.opengateranch.com](http://www.opengateranch.com)  
to view videos of the bull offering.



# BOBCAT BLUE SKY

This bull is among one of the most consistent we have ever used. Chosen for the balance point of weaning profit and extraordinary maternal history, there is persistent depth, soundness and carcass value here.



BOBCAT BLUE SKY Reference Sire.

## BOBCAT BLUE SKY

**PB AN** Bull ASA #3779393

SIRE: MUSGRAVE BIG SKY

MGS: EXAR DENVER 2002B

| CE   | BW   | WW   | YW  | MCE  | MILK | MWW  | MARB | REA  | \$API | \$TI |
|------|------|------|-----|------|------|------|------|------|-------|------|
| 15.7 | -0.2 | 99.9 | 163 | 11.1 | 20.7 | 70.6 | 0.92 | 0.45 | 148.1 | 98   |

# Bulls to sire OPTIMISM!

## 41 JF800 7/16 SM

Black Polled  
Bull ASA #4006695 JF800 BD: 1/27/2021

MUSGRAVE BIG SKY HSR RED MAGNUM C708  
BOBCAT BLUE SKY TAYLORF800  
BOBCAT LASS 411 OGRB712

365 Day Ultrasound

| BW | 10/14 WW | SALE WT | SC   | ADG  | WDA  | IMF  | BF   | REA   |
|----|----------|---------|------|------|------|------|------|-------|
| 93 | 928      | 1476    | 39.0 | 3.83 | 3.27 | 3.47 | 0.12 | 15.15 |

| CE   | BW  | WW    | YW    | MCE | MILK | MWW  | MB   | REA  | API   | TI   |
|------|-----|-------|-------|-----|------|------|------|------|-------|------|
| 14.8 | 0.4 | 100.5 | 163.1 | 9.9 | 22.5 | 72.7 | 0.53 | 0.87 | 145.9 | 97.4 |



## 42 JD499 1/2 SM

Black Polled  
Bull ASA #4007854 JD499 BD: 1/29/2021

MUSGRAVE BIG SKY OLF OTIS Y43  
BOBCAT BLUE SKY TAYLORD499  
BOBCAT LASS 411 TAYLORB442

365 Day Ultrasound

| BW | 10/14 WW | SALE WT | SC   | ADG  | WDA  | IMF  | BF   | REA   |
|----|----------|---------|------|------|------|------|------|-------|
| 92 | 1044     | 1532    | 37.0 | 3.73 | 3.42 | 4.20 | 0.26 | 12.88 |

| CE   | BW  | WW   | YW    | MCE  | MILK | MWW  | MB   | REA  | API   | TI   |
|------|-----|------|-------|------|------|------|------|------|-------|------|
| 15.0 | 0.6 | 96.0 | 152.4 | 10.6 | 23.0 | 71.0 | 0.53 | 0.67 | 143.8 | 94.0 |



JD499 Sells as Lot 42.



JF877 Sells as Lot 43.

# 43 JF877 1/4 SM

**Black** Polled  
**Bull ASA #4006704** JF877 **BD: 1/29/2021**

MUSGRAVE BIG SKY HSR RED MAGNUM C708  
 BOBCAT BLUE SKY OGRF877  
 BOBCAT LASS 411 OGRB621

| 365 Day Ultrasound |          |         |       |      |      |      |      |       |       |      |
|--------------------|----------|---------|-------|------|------|------|------|-------|-------|------|
| BW                 | 10/14 WW | SALE WT | SC    | ADG  | WDA  | IMF  | BF   | REA   |       |      |
| 96                 | 854      | 1308    | 36.0  | 3.48 | 2.89 | 4.48 | 0.15 | 10.38 |       |      |
| CE                 | BW       | WW      | YW    | MCE  | MILK | MWW  | MB   | REA   | API   | TI   |
| 15.1               | 0.8      | 91.5    | 145.1 | 10.2 | 21.0 | 66.7 | 0.72 | 0.42  | 150.3 | 94.8 |

# 44 JF599 1/2 SM

**Black** Polled  
**Bull ASA #4007860** JF599 **BD: 1/24/2021**

MUSGRAVE BIG SKY CS182  
 BOBCAT BLUE SKY F599T  
 BOBCAT LASS 411 OGRB664

| 365 Day Ultrasound |          |         |       |      |      |      |      |       |       |      |
|--------------------|----------|---------|-------|------|------|------|------|-------|-------|------|
| BW                 | 10/14 WW | SALE WT | SC    | ADG  | WDA  | IMF  | BF   | REA   |       |      |
| 93                 | 874      | 1387    | 37.5  | 4.04 | 3.04 | 4.49 | 0.19 | 12.80 |       |      |
| CE                 | BW       | WW      | YW    | MCE  | MILK | MWW  | MB   | REA   | API   | TI   |
| 12.1               | 1.8      | 91.8    | 145.8 | 7.9  | 20.6 | 66.5 | 0.66 | 0.67  | 143.0 | 92.5 |

# 45 JF806 1/2 SM

**Black** Polled  
**Bull ASA #4006703** JF806 **BD: 2/1/2021**

MUSGRAVE BIG SKY HSR RED MAGNUM C708  
 BOBCAT BLUE SKY OGRF806  
 BOBCAT LASS 411 OGRB744

| 365 Day Ultrasound |          |         |       |      |      |      |      |       |       |      |
|--------------------|----------|---------|-------|------|------|------|------|-------|-------|------|
| BW                 | 10/14 WW | SALE WT | SC    | ADG  | WDA  | IMF  | BF   | REA   |       |      |
| 105                | 894      | 1417    | 38.0  | 3.86 | 3.17 | 3.33 | 0.15 | 15.33 |       |      |
| CE                 | BW       | WW      | YW    | MCE  | MILK | MWW  | MB   | REA   | API   | TI   |
| 12.3               | 2.3      | 95.1    | 152.2 | 9.4  | 18.7 | 66.2 | 0.52 | 0.81  | 138.2 | 90.9 |

# 46 JF573 3/8 SM

**Black** Polled  
**Bull ASA #4007805** JF573 **BD: 1/23/2021**

MUSGRAVE BIG SKY CLRS CONSTITUTION 311 C  
 BOBCAT BLUE SKY TAYLORF573  
 BOBCAT LASS 411 TAYLORD499

| 365 Day Ultrasound |          |         |       |      |      |      |      |       |       |      |
|--------------------|----------|---------|-------|------|------|------|------|-------|-------|------|
| BW                 | 10/14 WW | SALE WT | SC    | ADG  | WDA  | IMF  | BF   | REA   |       |      |
| 88                 | 888      | 1375    | 36.5  | 3.18 | 3.01 | 2.69 | 0.16 | 12.68 |       |      |
| CE                 | BW       | WW      | YW    | MCE  | MILK | MWW  | MB   | REA   | API   | TI   |
| 15.6               | -0.4     | 85.6    | 140.2 | 10.9 | 17.6 | 60.4 | 0.54 | 0.58  | 145.0 | 88.9 |

# 47 JB436 1/2 SM

**Black** Polled  
**Bull ASA #4007868** JB436 **BD: 1/28/2021**

MUSGRAVE BIG SKY DIKEMANS SURE BET  
 BOBCAT BLUE SKY TAYLORB436  
 BOBCAT LASS 411 TAYLORW282

| 365 Day Ultrasound |          |         |       |      |      |      |      |       |       |      |
|--------------------|----------|---------|-------|------|------|------|------|-------|-------|------|
| BW                 | 10/14 WW | SALE WT | SC    | ADG  | WDA  | IMF  | BF   | REA   |       |      |
| 97                 | 986      | 1515    | 38.5  | 3.95 | 3.37 | 3.70 | 0.20 | 12.26 |       |      |
| CE                 | BW       | WW      | YW    | MCE  | MILK | MWW  | MB   | REA   | API   | TI   |
| 13.0               | 1.0      | 86.8    | 136.9 | 8.4  | 21.1 | 64.5 | 0.65 | 0.53  | 144.4 | 90.1 |



JD518 Sells as Lot 48.

# 48 JD518 1/2 SM

**Black** Polled  
**Bull ASA #4007852** JD518 **BD: 1/29/2021**

MUSGRAVE BIG SKY 3C CHUNK C440 BLK  
 BOBCAT BLUE SKY TAYLORD518  
 BOBCAT LASS 411 TAYLORY374

| 365 Day Ultrasound |          |         |       |      |      |      |      |       |       |      |
|--------------------|----------|---------|-------|------|------|------|------|-------|-------|------|
| BW                 | 10/14 WW | SALE WT | SC    | ADG  | WDA  | IMF  | BF   | REA   |       |      |
| 86                 | 950      | 1521    | 39.0  | 3.99 | 3.39 | 3.59 | 0.28 | 14.48 |       |      |
| CE                 | BW       | WW      | YW    | MCE  | MILK | MWW  | MB   | REA   | API   | TI   |
| 12.9               | 0.2      | 84.8    | 136.5 | 10.0 | 24.3 | 66.6 | 0.55 | 0.74  | 138.0 | 88.4 |

# S A V TERRITORY 7225

Chosen for his unreal early growth which captures that precious front end of profit to the ranch. They will bring what Schaff does best: show up and grow hard, making crossbred matings very simple.



S A V TERRITORY 7225 Reference Sire.

## S A V TERRITORY 7225

**PB AN** Bull ASA #3547316

SIRE: S A V RESOURCE 1441

MGS: S A V 004 DENSITY 4336

| CE | BW  | WW    | YW    | MCE | MILK | MWW  | MARB | REA  | \$API | \$TI |
|----|-----|-------|-------|-----|------|------|------|------|-------|------|
| 12 | 0.3 | 101.5 | 172.4 | 3.8 | 14.6 | 65.3 | 0.42 | 0.76 | 130.2 | 85.8 |

# Bulls to sire OPTIMISM!

## 49 JZ959 1/2 SM

Heterozygous Black Polled  
Bull ASA #4007974 JZ959

BD: 2/3/2021

S A V RESOURCE 1441 CDI TRUMP FORCE 156W  
S A V TERRITORY 7225 OGRZ959  
S A V EMBLYNETTE 3293 OGRW830

| 365 Day Ultrasound |          |         |       |      |      |      |      |       |       |      |
|--------------------|----------|---------|-------|------|------|------|------|-------|-------|------|
| BW                 | 10/14 WW | SALE WT | SC    | ADG  | WDA  | IMF  | BF   | REA   |       |      |
| 82                 | 884      | 1485    | 36.0  | 4.01 | 3.34 | 3.35 | 0.23 | 17.06 |       |      |
| CE                 | BW       | WW      | YW    | MCE  | MILK | MWW  | MB   | REA   | API   | TI   |
| 12.8               | 0.2      | 91.1    | 148.3 | 5.9  | 16.6 | 62.2 | 0.33 | 1.10  | 135.1 | 86.8 |

## 50 JE462 1/4 SM

Black Polled  
Bull ASA #4007947 JE462

BD: 2/2/2021

S A V RESOURCE 1441 HOOKS TRINITY 9T  
S A V TERRITORY 7225 OGRE462  
S A V EMBLYNETTE 3293 OGRC878

| 365 Day Ultrasound |          |         |       |      |      |      |      |       |       |      |
|--------------------|----------|---------|-------|------|------|------|------|-------|-------|------|
| BW                 | 10/14 WW | SALE WT | SC    | ADG  | WDA  | IMF  | BF   | REA   |       |      |
| 84                 | 850      | 1324    | 35.5  | 3.63 | 2.96 | 3.03 | 0.24 | 13.14 |       |      |
| CE                 | BW       | WW      | YW    | MCE  | MILK | MWW  | MB   | REA   | API   | TI   |
| 13.7               | -1.2     | 83.5    | 131.2 | 5.6  | 15.9 | 57.6 | 0.45 | 0.72  | 144.4 | 85.7 |

## 51 JA491 1/2 SM

Black Polled  
Bull ASA #4007927 JA491

BD: 2/17/2021

S A V RESOURCE 1441 HTP SVF IN DEW TIME  
S A V TERRITORY 7225 OGRA491  
S A V EMBLYNETTE 3293 SVRX597

| 365 Day Ultrasound |          |         |       |      |      |      |      |       |       |      |
|--------------------|----------|---------|-------|------|------|------|------|-------|-------|------|
| BW                 | 10/14 WW | SALE WT | SC    | ADG  | WDA  | IMF  | BF   | REA   |       |      |
| 89                 | 862      | 1305    | 38.0  | 3.72 | 3.02 | 3.29 | 0.23 | 12.08 |       |      |
| CE                 | BW       | WW      | YW    | MCE  | MILK | MWW  | MB   | REA   | API   | TI   |
| 12.6               | 0.2      | 83.1    | 127.3 | 5.2  | 16.1 | 57.6 | 0.31 | 0.66  | 132.4 | 80.0 |





JE608 Sells as Lot 52.

# 52 JE608 3/8 SM

**Black** Polled  
**Bull ASA #4007955** JE608 **BD: 2/5/2021**

S A V RESOURCE 1441 GIBBS 0601X RAISINCAIN  
 S A V TERRITORY 7225 OGRE608  
 S A V EMBLYNETTE 3293 HILLS T20 TENX 106GY

| 365 Day Ultrasound |          |         |       |      |      |      |      |       |       |      |
|--------------------|----------|---------|-------|------|------|------|------|-------|-------|------|
| BW                 | 10/14 WW | SALE WT | SC    | ADG  | WDA  | IMF  | BF   | REA   |       |      |
| 90                 | 868      | 1385    | 36.0  | 3.62 | 3.12 | 3.49 | 0.22 | 14.29 |       |      |
| CE                 | BW       | WW      | YW    | MCE  | MILK | MWW  | MB   | REA   | API   | TI   |
| 10.9               | 1.1      | 91.4    | 149.8 | 5.3  | 19.3 | 64.9 | 0.41 | 0.88  | 134.6 | 87.5 |

# 53 JA496 3/8 SM

**Black** Polled  
**Bull ASA #4007928** JA496 **BD: 2/10/2021**

S A V RESOURCE 1441 OGRYR611  
 S A V TERRITORY 7225 OGRA496  
 S A V EMBLYNETTE 3293 OGRW858

| 365 Day Ultrasound |          |         |       |      |      |      |      |       |       |      |
|--------------------|----------|---------|-------|------|------|------|------|-------|-------|------|
| BW                 | 10/14 WW | SALE WT | SC    | ADG  | WDA  | IMF  | BF   | REA   |       |      |
| 80                 | 850      | 1296    | 38.5  | 3.14 | 2.94 | 3.94 | 0.18 | 12.87 |       |      |
| CE                 | BW       | WW      | YW    | MCE  | MILK | MWW  | MB   | REA   | API   | TI   |
| 12.7               | -0.4     | 77.8    | 119.4 | 6.0  | 23.8 | 62.6 | 0.47 | 0.67  | 137.6 | 82.3 |

# 55 JA523 1/8 SM

**Black** Polled  
**Bull ASA #4007929** JA523 **BD: 2/21/2021**

S A V RESOURCE 1441 TFS BLACK ONYX 1442Y  
 S A V TERRITORY 7225 A523  
 S A V EMBLYNETTE 3293 X23

| 365 Day Ultrasound |          |         |       |      |      |      |      |       |       |      |
|--------------------|----------|---------|-------|------|------|------|------|-------|-------|------|
| BW                 | 10/14 WW | SALE WT | SC    | ADG  | WDA  | IMF  | BF   | REA   |       |      |
| 81                 | 828      | 1308    | 36.0  | 3.15 | 3.06 | 2.56 | 0.18 | 13.15 |       |      |
| CE                 | BW       | WW      | YW    | MCE  | MILK | MWW  | MB   | REA   | API   | TI   |
| 13.1               | -0.8     | 79.0    | 126.2 | 6.5  | 21.9 | 61.3 | 0.31 | 0.43  | 152.6 | 93.7 |

# 56 JC944 1/4 SM

**Black** Polled  
**Bull ASA #4007942** JC944 **BD: 2/20/2021**

S A V RESOURCE 1441 OGRZT016  
 S A V TERRITORY 7225 OGRC944  
 S A V EMBLYNETTE 3293 SVR S298

| 365 Day Ultrasound |          |         |       |      |      |      |      |       |       |      |
|--------------------|----------|---------|-------|------|------|------|------|-------|-------|------|
| BW                 | 10/14 WW | SALE WT | SC    | ADG  | WDA  | IMF  | BF   | REA   |       |      |
| 98                 | 842      | 1250    | 40.0  | 3.27 | 2.90 | 3.30 | 0.23 | 13.73 |       |      |
| CE                 | BW       | WW      | YW    | MCE  | MILK | MWW  | MB   | REA   | API   | TI   |
| 10.1               | 1.1      | 80.4    | 127.2 | 5.3  | 13.5 | 53.6 | 0.38 | 0.63  | 131.5 | 78.3 |





# S A V RENEW 8132

Chosen for his calving ease potential and fantastic dam, this sire group will set you up to make fancy females with an excellent platform for profit.



S A V RENEW 8132 Reference Sire.

## S A V RENEW 8132

**PB AN** Bull ASA #3928419

SIRE: S A V RENOWN 3439

MGS: CONNEALY CAVALRY 1149

| CE  | BW  | WW   | YW    | MCE | MILK | MWW  | MARB | REA  | \$API | \$TI |
|-----|-----|------|-------|-----|------|------|------|------|-------|------|
| 9.4 | 0.4 | 83.5 | 133.1 | 4.7 | 15.6 | 57.3 | 0.38 | 0.53 | 116.2 | 73.1 |

# Bulls to sire OPTIMISM!

## 57 JE94 3/8 SM

Black Polled  
Bull ASA #4007957 JE94 BD: 2/17/2021

S A V RENOWN 3439

GIBBS 0601X RAISINCAIN

S A V RENEW 8132

OGRE94

S A V BLACKCAP MAY 4593

OGRX14

365 Day Ultrasound

| BW | 10/14 WW | SALE WT | SC   | ADG  | WDA  | IMF  | BF   | REA   |
|----|----------|---------|------|------|------|------|------|-------|
| 90 | 876      | 1528    | 39.0 | 3.96 | 3.57 | 2.50 | 0.23 | 15.48 |

| CE  | BW  | WW   | YW    | MCE | MILK | MWW  | MB   | REA  | API   | TI   |
|-----|-----|------|-------|-----|------|------|------|------|-------|------|
| 8.8 | 2.1 | 92.2 | 151.3 | 5.4 | 21.7 | 67.8 | 0.30 | 0.89 | 127.5 | 84.2 |



JE94 Sells as Lot 57.

## 58 JE558 1/4 SM

Black Polled  
Bull ASA #4007953 JE558 BD: 2/6/2021

S A V RENOWN 3439

HOOK'S BALTIC 17B

S A V RENEW 8132

OGRE558

S A V BLACKCAP MAY 4593

OGRY301

365 Day Ultrasound

| BW | 10/14 WW | SALE WT | SC   | ADG  | WDA  | IMF  | BF   | REA   |
|----|----------|---------|------|------|------|------|------|-------|
| 87 | 812      | 1496    | 39.0 | 4.03 | 3.40 | 3.24 | 0.29 | 13.81 |

| CE   | BW  | WW   | YW    | MCE | MILK | MWW  | MB   | REA  | API   | TI   |
|------|-----|------|-------|-----|------|------|------|------|-------|------|
| 10.9 | 1.2 | 87.5 | 149.2 | 5.9 | 15.5 | 59.2 | 0.39 | 0.57 | 133.4 | 83.9 |

## 59 JE4741 1/4 SM

Black Polled  
Bull ASA #4007949 JE4741 BD: 2/1/2021

S A V RENOWN 3439

OGRZT016

S A V RENEW 8132

OGRE474

S A V BLACKCAP MAY 4593

OGRX747

365 Day Ultrasound

| BW | 10/14 WW | SALE WT | SC   | ADG  | WDA  | IMF  | BF   | REA   |
|----|----------|---------|------|------|------|------|------|-------|
| 80 | 818      | 1313    | 37.0 | 3.30 | 2.92 | 3.15 | 0.22 | 14.43 |

| CE  | BW  | WW   | YW    | MCE | MILK | MWW  | MB   | REA  | API   | TI   |
|-----|-----|------|-------|-----|------|------|------|------|-------|------|
| 9.8 | 1.1 | 82.0 | 128.3 | 5.2 | 20.7 | 61.7 | 0.31 | 0.60 | 125.4 | 78.5 |

**60 JE4742 1/4 SM**

Black Polled  
Bull ASA #4007950 JE4742 BD: 2/1/2021

S A V RENOWN 3439 OGRZT016  
S A V RENEW 8132 OGR474  
S A V BLACKCAP MAY 4593 OGRX747

| 365 Day Ultrasound |          |         |       |      |      |      |      |       |       |      |
|--------------------|----------|---------|-------|------|------|------|------|-------|-------|------|
| BW                 | 10/14 WW | SALE WT | SC    | ADG  | WDA  | IMF  | BF   | REA   |       |      |
| 79                 | 842      | 1433    | 37.0  | 3.32 | 3.21 | 2.65 | 0.14 | 13.63 |       |      |
| CE                 | BW       | WW      | YW    | MCE  | MILK | MWW  | MB   | REA   | API   | TI   |
| 9.8                | 1.1      | 82.0    | 128.3 | 5.2  | 20.7 | 61.7 | 0.31 | 0.60  | 125.4 | 78.5 |

**61 JE487 1/4 SM**

Black Polled  
Bull ASA #4007951 JE487 BD: 2/5/2021

S A V RENOWN 3439 HOOK'S BALTIC 17B  
S A V RENEW 8132 OGR487  
S A V BLACKCAP MAY 4593 OGRZ408

| 365 Day Ultrasound |          |         |      |      |      |      |      |       |       |      |
|--------------------|----------|---------|------|------|------|------|------|-------|-------|------|
| BW                 | 10/14 WW | SALE WT | SC   | ADG  | WDA  | IMF  | BF   | REA   |       |      |
| 95                 | 790      | 1102    | 35.0 | 2.70 | 2.44 | 2.42 | 0.13 | 10.19 |       |      |
| CE                 | BW       | WW      | YW   | MCE  | MILK | MWW  | MB   | REA   | API   | TI   |
| 9.5                | 0.8      | 64.7    | 91.5 | 5.2  | 12.9 | 45.2 | 0.34 | 0.41  | 116.6 | 67.7 |

**62 JZ462 3/8 SM**

Black Polled  
Bull ASA #4007971 JZ462 BD: 2/20/2021

S A V RENOWN 3439 HTP SVF IN DEW TIME  
S A V RENEW 8132 OGRZ462  
S A V BLACKCAP MAY 4593 OGR731

| 365 Day Ultrasound |          |         |       |      |      |      |      |       |       |      |
|--------------------|----------|---------|-------|------|------|------|------|-------|-------|------|
| BW                 | 10/14 WW | SALE WT | SC    | ADG  | WDA  | IMF  | BF   | REA   |       |      |
| 90                 | 754      | 1246    | 36.0  | 2.73 | 2.89 | 2.05 | 0.18 | 13.13 |       |      |
| CE                 | BW       | WW      | YW    | MCE  | MILK | MWW  | MB   | REA   | API   | TI   |
| 12.0               | 0.1      | 68.8    | 103.7 | 5.4  | 12.8 | 47.1 | 0.26 | 0.48  | 118.0 | 69.8 |

**63 JA568 1/4 SM**

Black Polled  
Bull ASA #4007931 JA568 BD: 2/21/2021

S A V RENOWN 3439 SVRW909  
S A V RENEW 8132 OGRA568  
S A V BLACKCAP MAY 4593 OGRX100

| 365 Day Ultrasound |          |         |      |      |      |      |      |       |       |      |
|--------------------|----------|---------|------|------|------|------|------|-------|-------|------|
| BW                 | 10/14 WW | SALE WT | SC   | ADG  | WDA  | IMF  | BF   | REA   |       |      |
| 86                 | 770      | 1122    | 36.0 | 3.23 | 2.59 | 2.74 | 0.16 | 13.25 |       |      |
| CE                 | BW       | WW      | YW   | MCE  | MILK | MWW  | MB   | REA   | API   | TI   |
| 10.0               | 0.0      | 66.7    | 92.2 | 5.4  | 19.8 | 53.1 | 0.34 | 0.59  | 123.3 | 70.8 |



JY353 Sells as Lot 64.

**64 JY353 1/4 SM**

Black Polled  
Bull ASA #4007968 JY353 BD: 2/18/2021

S A V RENOWN 3439  
S A V RENEW 8132 OGRY353D  
S A V BLACKCAP MAY 4593 OGRS41

| 365 Day Ultrasound |          |         |       |      |      |      |      |       |       |      |
|--------------------|----------|---------|-------|------|------|------|------|-------|-------|------|
| BW                 | 10/14 WW | SALE WT | SC    | ADG  | WDA  | IMF  | BF   | REA   |       |      |
| 95                 | 892      | 1467    | 39.0  | 3.93 | 3.42 | 2.69 | 0.18 | 16.00 |       |      |
| CE                 | BW       | WW      | YW    | MCE  | MILK | MWW  | MB   | REA   | API   | TI   |
| 10.0               | 1.0      | 80.0    | 128.0 | 5.1  | 18.2 | 58.1 | 0.29 | 0.68  | 114.3 | 77.2 |



JZ971 Sells as Lot 65.

**65 JZ971 3/4 SM**

Black Polled  
Bull ASA #4007771 JZ971 BD: 3/5/2021

MR NLC UPGRADE U8676 CDI TRUMP FORCE 156W  
TJ MAIN EVENT 503B OGRZ971  
TJ MISS NEW DAY U14 OGRU792

| 365 Day Ultrasound |          |         |       |      |      |      |      |       |       |      |
|--------------------|----------|---------|-------|------|------|------|------|-------|-------|------|
| BW                 | 10/14 WW | SALE WT | SC    | ADG  | WDA  | IMF  | BF   | REA   |       |      |
| 90                 | 850      | 1423    | 35.5  | 3.75 | 3.44 | 3.15 | 0.18 | 14.24 |       |      |
| CE                 | BW       | WW      | YW    | MCE  | MILK | MWW  | MB   | REA   | API   | TI   |
| 12.9               | 0.3      | 89.1    | 135.8 | 6.2  | 20.7 | 65.2 | 0.25 | 0.99  | 136.7 | 85.5 |

# 66 JC107 1/2 SM

Black Polled  
Bull ASA #4007939 JC107 BD: 3/9/2021

MR NLC UPGRADE U8676 GIBBS 0601X RAISINCAIN  
TJ MAIN EVENT 503B OGRC107  
TJ MISS NEW DAY U14 M113

365 Day Ultrasound

| BW   | 10/14 WW | SALE WT | SC    | ADG  | WDA  | IMF  | BF   | REA   |       |      |
|------|----------|---------|-------|------|------|------|------|-------|-------|------|
| 94   | 894      | 1413    | 36.5  | 3.55 | 3.45 | 1.47 | 0.09 | 12.01 |       |      |
| CE   | BW       | WW      | YW    | MCE  | MILK | MWW  | MB   | REA   | API   | TI   |
| 10.5 | 1.4      | 85.9    | 141.3 | 4.4  | 25.5 | 68.4 | 0.16 | 0.79  | 122.0 | 80.2 |

# 67 JC979 1/2 SM

Black Polled  
Bull ASA #4007793 JC979 BD: 3/4/2021

MR NLC UPGRADE U8676 W/C UNITED 956Y  
TJ MAIN EVENT 503B OGRC979  
TJ MISS NEW DAY U14 OGRY306

365 Day Ultrasound

| BW   | 10/14 WW | SALE WT | SC    | ADG  | WDA  | IMF  | BF   | REA   |       |      |
|------|----------|---------|-------|------|------|------|------|-------|-------|------|
| 83   | 744      | 1194    | 34.5  | 3.04 | 2.85 | 2.42 | 0.09 | 13.83 |       |      |
| CE   | BW       | WW      | YW    | MCE  | MILK | MWW  | MB   | REA   | API   | TI   |
| 12.9 | -0.2     | 83.3    | 131.2 | 5.8  | 24.6 | 66.2 | 0.21 | 0.75  | 124.6 | 80.2 |

# 68 JB627 7/8 SM

Black Polled  
Bull ASA #4007935 JB627 BD: 2/21/2021

CCR COWBOY CUT 5048Z HSF HIGH ROLLER 12T  
TJ NORTHWARD 573C OGRB627  
TJ 59X SVRZ432

365 Day Ultrasound

| BW  | 10/14 WW | SALE WT | SC    | ADG  | WDA  | IMF  | BF   | REA   |       |      |
|-----|----------|---------|-------|------|------|------|------|-------|-------|------|
| 98  | 938      | 1457    | 37.0  | 3.41 | 3.43 | 1.60 | 0.18 | 14.55 |       |      |
| CE  | BW       | WW      | YW    | MCE  | MILK | MWW  | MB   | REA   | API   | TI   |
| 7.5 | 4.0      | 90.9    | 132.8 | 5.7  | 32.5 | 77.9 | 0.11 | 0.94  | 114.2 | 78.5 |

# 69 JB651 3/4 SM

Black Polled  
Bull ASA #4007937 JB651 BD: 2/20/2021

CCR COWBOY CUT 5048Z OGRZU171  
TJ NORTHWARD 573C OGRB651  
TJ 59X SVR U120

365 Day Ultrasound

| BW  | 10/14 WW | SALE WT | SC    | ADG  | WDA  | IMF  | BF   | REA   |       |      |
|-----|----------|---------|-------|------|------|------|------|-------|-------|------|
| 98  | 848      | 1434    | 36.0  | 3.52 | 3.36 | 2.49 | 0.13 | 13.83 |       |      |
| CE  | BW       | WW      | YW    | MCE  | MILK | MWW  | MB   | REA   | API   | TI   |
| 7.2 | 3.6      | 89.2    | 141.2 | 5.3  | 24.4 | 69.0 | 0.37 | 0.82  | 127.8 | 82.1 |

# 70 JZ390 1/2 SM

Black Polled  
Bull ASA #4007827 JZ390 BD: 2/9/2021

S A V FINAL ANSWER 0035 WS BEEF MAKER R13  
TJ Z54 TAYLORZ390  
TJ MISS BISMARK X1 TAYLORL180

365 Day Ultrasound

| BW   | 10/14 WW | SALE WT | SC    | ADG  | WDA  | IMF  | BF   | REA   |       |      |
|------|----------|---------|-------|------|------|------|------|-------|-------|------|
| 92   | 928      | 1353    | 39.0  | 3.49 | 3.07 | 1.59 | 0.22 | 14.46 |       |      |
| CE   | BW       | WW      | YW    | MCE  | MILK | MWW  | MB   | REA   | API   | TI   |
| 12.9 | -0.5     | 83.4    | 121.1 | 8.7  | 26.5 | 68.1 | 0.17 | 0.77  | 124.1 | 79.0 |

# 71 JD71 7/8 SM

Black Polled/Scurred  
Bull ASA #4012159 JD71 BD: 2/21/2021

MCM TOP GRADE 018X 3C CHUNK C440 BLK  
HOOK'S BOUNTY 6B OGRD71  
HOOK'S YUMA 49Y SVRZ359

365 Day Ultrasound

| BW  | 10/14 WW | SALE WT | SC    | ADG  | WDA  | IMF  | BF   | REA   |       |      |
|-----|----------|---------|-------|------|------|------|------|-------|-------|------|
| 98  | 978      | 1551    | 41.0  | 4.09 | 3.66 | 1.69 | 0.15 | 14.85 |       |      |
| CE  | BW       | WW      | YW    | MCE  | MILK | MWW  | MB   | REA   | API   | TI   |
| 7.3 | 2.8      | 78.1    | 120.9 | 6.9  | 33.0 | 72.0 | 0.05 | 1.10  | 117.8 | 71.8 |

## Notes on Ultrasound

Our Ultrasound Scan technician, Sonja Gregory told us about having to re-certify this year as a technician authorized by CUP Labs who standardize the data received and submit it to respective Breed Organizations. She had to travel to Kansas for a two day process of certification. First day was spent actually scanning cattle. These cattle were subsequently slaughtered, and their carcasses measured against the scans produced to test for her ability to accurately capture images. The second day was classroom testing regarding technical specs and field application. We were impressed that such a thorough process is in place for ensuring accurate and consistent results through ultrasound, and American Simmental Association continues to insist that such measured data is a crucial component to building a powerful EPD platform. At Open Gate, we still believe that measuring phenotype is critical to understanding trends in our breeding program, and in knowing what targets we are meeting or moving according to what our customers need.

**72 JB027 3/4 SM**

Black Polled/Scurred  
 Bull ASA #4007933 JB027 BD: 2/23/2021

MCM TOP GRADE 018X SVR W732  
 HOOK'S BOUNTY 6B OGRB027  
 HOOK'S YUMA 49Y SPRING VALLEY K697

| 365 Day Ultrasound |          |         |       |      |      |      |      |       |       |      |
|--------------------|----------|---------|-------|------|------|------|------|-------|-------|------|
| BW                 | 10/14 WW | SALE WT | SC    | ADG  | WDA  | IMF  | BF   | REA   |       |      |
| 99                 | 870      | 1436    | 39.0  | 3.92 | 3.39 | 1.57 | 0.13 | 13.98 |       |      |
| CE                 | BW       | WW      | YW    | MCE  | MILK | MWW  | MB   | REA   | API   | TI   |
| 6.4                | 3.6      | 82.1    | 127.4 | 5.4  | 36.8 | 77.7 | 0.09 | 0.98  | 121.3 | 74.1 |



JE434 Sells as Lot 74.



JE540 Sells as Lot 75.

**76 JF593 1/2 SM**

Red Polled  
 Bull ASA #4007847 JF593 BD: 1/31/2021

HOOKS TRINITY 9T BROWN 3K STAKEHOLDER X7870  
 LEACHMAN CADILLAC L025A TAYLORF593  
 REMPE STABILIZER YD032 TAYLORZ383

| 365 Day Ultrasound |          |         |       |      |      |      |      |       |       |      |
|--------------------|----------|---------|-------|------|------|------|------|-------|-------|------|
| BW                 | 10/14 WW | SALE WT | SC    | ADG  | WDA  | IMF  | BF   | REA   |       |      |
| 93                 | 882      | 1348    | 37.0  | 3.51 | 3.00 | 2.73 | 0.14 | 10.81 |       |      |
| CE                 | BW       | WW      | YW    | MCE  | MILK | MWW  | MB   | REA   | API   | TI   |
| 12.7               | -0.3     | 77.0    | 121.9 | 5.7  | 25.6 | 64.1 | 0.33 | 0.40  | 126.8 | 78.5 |

**73 JA550 3/4 SM**

Black Polled  
 Bull ASA #4007930 JA550 BD: 3/4/2021

MCM TOP GRADE 018X HOOK'S INFINITI 10U  
 HOOK'S BOUNTY 6B OGRA550  
 HOOK'S YUMA 49Y SVRX210

| 365 Day Ultrasound |          |         |       |      |      |      |      |       |       |      |
|--------------------|----------|---------|-------|------|------|------|------|-------|-------|------|
| BW                 | 10/14 WW | SALE WT | SC    | ADG  | WDA  | IMF  | BF   | REA   |       |      |
| 87                 | 798      | 1370    | 38.0  | 3.61 | 3.30 | 2.56 | 0.17 | 15.33 |       |      |
| CE                 | BW       | WW      | YW    | MCE  | MILK | MWW  | MB   | REA   | API   | TI   |
| 9.5                | 2.2      | 83.2    | 134.5 | 6.4  | 29.5 | 71.0 | 0.30 | 1.06  | 140.7 | 81.7 |

**74 JE434 7/8 SM**

Black Polled  
 Bull ASA #4007755 JE434 BD: 2/23/2021

MCM TOP GRADE 018X OLF OTIS Y43  
 HOOK'S BOUNTY 6B OGRE434  
 HOOK'S YUMA 49Y OGRC895

| 365 Day Ultrasound |          |         |       |      |      |      |      |       |       |      |
|--------------------|----------|---------|-------|------|------|------|------|-------|-------|------|
| BW                 | 10/14 WW | SALE WT | SC    | ADG  | WDA  | IMF  | BF   | REA   |       |      |
| 85                 | 784      | 1296    | 37.0  | 3.41 | 3.04 | 2.58 | 0.23 | 13.88 |       |      |
| CE                 | BW       | WW      | YW    | MCE  | MILK | MWW  | MB   | REA   | API   | TI   |
| 13.1               | 0.3      | 79.1    | 124.0 | 9.1  | 29.0 | 68.5 | 0.10 | 0.96  | 133.2 | 77.0 |

**75 JE540 3/4 SM**

Red Polled  
 Bull ASA #4007871 JE540 BD: 2/2/2021

HOOKS TRINITY 9T BW679  
 LEACHMAN CADILLAC L025A TAYLORE540  
 REMPE STABILIZER YD032 TAYLORS182

| 365 Day Ultrasound |          |         |       |      |      |      |      |       |       |      |
|--------------------|----------|---------|-------|------|------|------|------|-------|-------|------|
| BW                 | 10/14 WW | SALE WT | SC    | ADG  | WDA  | IMF  | BF   | REA   |       |      |
| 87                 | 882      | 1340    | 36.5  | 3.52 | 2.99 | 1.90 | 0.18 | 14.44 |       |      |
| CE                 | BW       | WW      | YW    | MCE  | MILK | MWW  | MB   | REA   | API   | TI   |
| 11.1               | 0.7      | 75.0    | 117.1 | 5.6  | 25.7 | 63.2 | 0.22 | 0.71  | 119.6 | 75.3 |

**77 JG211 3/8 SM**

Black Polled  
 Bull ASA #4007767 JG211 BD: 1/12/2021

CONNEALY BLACK GRANITE TJ COWBOY UP 529B  
 QHF WWA BLACK ONYX 5Q11 G211  
 WILKS BLACKCAP OD82 OGRY922

| 365 Day Ultrasound |          |         |       |      |      |      |      |       |       |      |
|--------------------|----------|---------|-------|------|------|------|------|-------|-------|------|
| BW                 | 10/14 WW | SALE WT | SC    | ADG  | WDA  | IMF  | BF   | REA   |       |      |
| 80                 | 896      | 1410    | 36.0  | 4.35 | 3.01 | 2.88 | 0.12 | 12.10 |       |      |
| CE                 | BW       | WW      | YW    | MCE  | MILK | MWW  | MB   | REA   | API   | TI   |
| 14.6               | -0.5     | 96.7    | 152.5 | 9.4  | 24.4 | 72.7 | 0.44 | 0.72  | 143.9 | 93.4 |

# 78 JG280 1/4 SM

Black Polled  
Bull ASA #4007964 JG280 BD: 1/20/2021

CONNEALY BLACK GRANITE TJ COWBOY UP 529B  
QHF WWA BLACK ONYX 5Q11 G280  
WILKS BLACKCAP 0D82 OGRW825

365 Day Ultrasound

| BW   | 10/14 WW | SALE WT | SC    | ADG  | WDA  | IMF  | BF   | REA   |       |      |
|------|----------|---------|-------|------|------|------|------|-------|-------|------|
| 87   | 892      | 1391    | 32.0  | 3.66 | 3.02 | 4.24 | 0.21 | 10.63 |       |      |
| CE   | BW       | WW      | YW    | MCE  | MILK | MWW  | MB   | REA   | API   | TI   |
| 12.6 | 0.9      | 97.4    | 153.9 | 8.5  | 21.8 | 70.4 | 0.54 | 0.56  | 145.2 | 93.7 |

# 79 JY28 1/4 SM

Black Polled  
Bull ASA #4007967 JY28 BD: 2/17/2021

CONNEALY STIMULUS 8419 APEX FOCUS 053  
CONNEALY SPUR SVRY28  
JAZZA OF CONANGA 8594 SVR S692

365 Day Ultrasound

| BW   | 10/14 WW | SALE WT | SC    | ADG  | WDA  | IMF  | BF   | REA   |       |      |
|------|----------|---------|-------|------|------|------|------|-------|-------|------|
| 95   | 860      | 1422    | 36.0  | 3.77 | 3.31 | 3.54 | 0.16 | 13.38 |       |      |
| CE   | BW       | WW      | YW    | MCE  | MILK | MWW  | MB   | REA   | API   | TI   |
| 11.6 | 1.5      | 83.5    | 130.9 | 7.1  | 19.2 | 60.9 | 0.49 | 0.50  | 142.0 | 82.9 |

# 80 JZ533 1/2 SM

Black Polled  
Bull ASA #4007972 JZ533 BD: 3/5/2021

CONNEALY STIMULUS 8419 CDI TRUMP FORCE 156W  
CONNEALY SPUR OGRZ533  
JAZZA OF CONANGA 8594 SPRING VALLEY P109

365 Day Ultrasound

| BW   | 10/14 WW | SALE WT | SC    | ADG  | WDA  | IMF  | BF   | REA   |       |      |
|------|----------|---------|-------|------|------|------|------|-------|-------|------|
| 96   | 824      | 1377    | 37.0  | 4.06 | 3.33 | 3.30 | 0.22 | 14.54 |       |      |
| CE   | BW       | WW      | YW    | MCE  | MILK | MWW  | MB   | REA   | API   | TI   |
| 10.8 | 2.0      | 86.1    | 134.8 | 6.6  | 20.0 | 62.9 | 0.51 | 0.70  | 141.9 | 84.9 |

# 81 JY905 1/2 SM

Black Polled  
Bull ASA #4011948 JY905 BD: 3/6/2021

CONNEALY STIMULUS 8419 SVR S804  
CONNEALY SPUR OGRY905  
JAZZA OF CONANGA 8594 OGRU795

365 Day Ultrasound

| BW   | 10/14 WW | SALE WT | SC    | ADG  | WDA  | IMF  | BF   | REA   |       |      |
|------|----------|---------|-------|------|------|------|------|-------|-------|------|
| 95   | 766      | 1288    | 37.0  | 2.93 | 3.11 | 2.03 | 0.16 | 12.66 |       |      |
| CE   | BW       | WW      | YW    | MCE  | MILK | MWW  | MB   | REA   | API   | TI   |
| 11.1 | 1.6      | 72.3    | 108.4 | 7.3  | 20.9 | 57.0 | 0.40 | 0.36  | 125.7 | 73.6 |

# 82 JX735 1/2 SM

Black Polled  
Bull ASA #4007798 JX735 BD: 3/4/2021

CONNEALY STIMULUS 8419 BLACK SHAMROCK E157  
CONNEALY SPUR OGRX735  
JAZZA OF CONANGA 8594 OGRU802

365 Day Ultrasound

| BW  | 10/14 WW | SALE WT | SC    | ADG  | WDA  | IMF  | BF   | REA   |       |      |
|-----|----------|---------|-------|------|------|------|------|-------|-------|------|
| 105 | 918      | 1556    | 39.0  | 4.33 | 3.77 | 1.86 | 0.18 | 14.03 |       |      |
| CE  | BW       | WW      | YW    | MCE  | MILK | MWW  | MB   | REA   | API   | TI   |
| 7.8 | 5.0      | 91.1    | 157.5 | 6.2  | 21.9 | 67.4 | 0.35 | 0.68  | 125.9 | 80.8 |



JX735 Sells as Lot 82.

# 83 JF818 7/8 SM

Black Polled  
Bull ASA #4007719 JF818 BD: 2/16/2021

MR NLC UPGRADE U8676 HOOK'S EASTWOOD 30C  
GIBBS 0601X RAISINCAIN OGRF818  
ASR SWEET DREAMS M229 OGRZ442

365 Day Ultrasound

| BW  | 10/14 WW | SALE WT | SC    | ADG  | WDA  | IMF  | BF   | REA   |       |      |
|-----|----------|---------|-------|------|------|------|------|-------|-------|------|
| 96  | 888      | 1472    | 39.0  | 4.05 | 3.42 | 2.19 | 0.09 | 15.07 |       |      |
| CE  | BW       | WW      | YW    | MCE  | MILK | MWW  | MB   | REA   | API   | TI   |
| 8.8 | 3.1      | 97.4    | 149.8 | 5.1  | 27.0 | 75.7 | 0.12 | 1.21  | 128.9 | 89.1 |



# 84 JE455 7/8 SM

**Black** Polled  
**Bull ASA #4007946** JE455 **BD: 2/8/2021**

KS CAPTN JACK T518 HOOKS TRINITY 9T  
 SVRW909 OGRE455  
 MISS SPRING VALLEY J499 OGR933

| 365 Day Ultrasound |          |         |       |      |      |      |      |       |       |      |
|--------------------|----------|---------|-------|------|------|------|------|-------|-------|------|
| BW                 | 10/14 WW | SALE WT | SC    | ADG  | WDA  | IMF  | BF   | REA   |       |      |
| 86                 | 894      | 1271    | 35.0  | 3.28 | 2.87 | 2.68 | 0.16 | 13.24 |       |      |
| CE                 | BW       | WW      | YW    | MCE  | MILK | MWW  | MB   | REA   | API   | TI   |
| 10.0               | 0.1      | 73.4    | 103.8 | 5.7  | 23.4 | 60.1 | 0.27 | 0.86  | 142.4 | 80.7 |

# 85 JZ382 3/4 SM

**Black** Polled  
**Bull ASA #4007824** JZ382 **BD: 2/1/2021**

TJ MAKERS MARK 215Y TJ 57J THE GAMBLER  
 SHSF FREIGHTLINER D10 TAYLORZ382  
 HOOKS PUNKY 5P SV L160

| 365 Day Ultrasound |          |         |       |      |      |      |      |       |       |      |
|--------------------|----------|---------|-------|------|------|------|------|-------|-------|------|
| BW                 | 10/14 WW | SALE WT | SC    | ADG  | WDA  | IMF  | BF   | REA   |       |      |
| 96                 | 952      | 1516    | 38.5  | 4.30 | 3.40 | 2.17 | 0.14 | 13.63 |       |      |
| CE                 | BW       | WW      | YW    | MCE  | MILK | MWW  | MB   | REA   | API   | TI   |
| 9.6                | 2.4      | 87.5    | 138.7 | 8.3  | 25.2 | 68.9 | 0.20 | 1.02  | 129.7 | 80.8 |

# 86 JE571 3/4 SM

**Heterozygous Black** Polled  
**Bull ASA #4007954** JE571 **BD: 2/19/2021**

CCR COWBOY CUT 5048Z WS ZENITH Z55  
 CCR 707 COWBOY 6055B OGRE571  
 S D S PRINCESS 707T OGRA574

| 365 Day Ultrasound |          |         |       |      |      |      |      |       |       |      |
|--------------------|----------|---------|-------|------|------|------|------|-------|-------|------|
| BW                 | 10/14 WW | SALE WT | SC    | ADG  | WDA  | IMF  | BF   | REA   |       |      |
| 87                 | 806      | 1319    | 36.5  | 3.11 | 3.07 | 2.52 | 0.23 | 12.12 |       |      |
| CE                 | BW       | WW      | YW    | MCE  | MILK | MWW  | MB   | REA   | API   | TI   |
| 11.6               | 0.9      | 83.6    | 126.5 | 7.4  | 20.7 | 62.5 | 0.33 | 0.80  | 145.9 | 82.6 |

# 87 JF787 5/8 SM

**Black** Polled  
**Bull ASA #4007714** JF787 **BD: 3/5/2021**

OGRZT016 HOOK'S EASTWOOD 30C  
 OGR EASTON OGRF787  
 OGRA931 OGRX665

| 365 Day Ultrasound |          |         |       |      |      |      |      |       |       |      |
|--------------------|----------|---------|-------|------|------|------|------|-------|-------|------|
| BW                 | 10/14 WW | SALE WT | SC    | ADG  | WDA  | IMF  | BF   | REA   |       |      |
| 105                | 804      | 1451    | 37.5  | 3.41 | 3.51 | 3.12 | 0.23 | 13.74 |       |      |
| CE                 | BW       | WW      | YW    | MCE  | MILK | MWW  | MB   | REA   | API   | TI   |
| 6.7                | 4.5      | 98.6    | 156.2 | 4.3  | 23.4 | 72.6 | 0.28 | 0.85  | 126.0 | 85.5 |



HA495 Sells as Lot 89.

# 89 HA495 1/2 SM

**Black** Polled  
**Bull ASA #3902610** HA495 **BD: 10/4/2020**

HOOK'S BALTIC 17B TFS BLACK ONYX 1442Y  
 FC892 OGRA495  
 OGR931 OGRW820

| 365 Day Ultrasound |          |         |       |      |      |      |      |       |       |      |
|--------------------|----------|---------|-------|------|------|------|------|-------|-------|------|
| BW                 | 10/14 WW | SALE WT | SC    | ADG  | WDA  | IMF  | BF   | REA   |       |      |
| 96                 | 1260     | 1851    | 43.5  | 3.85 | 3.27 | 2.26 | 0.11 | 16.79 |       |      |
| CE                 | BW       | WW      | YW    | MCE  | MILK | MWW  | MB   | REA   | API   | TI   |
| 10.2               | 2.3      | 79.0    | 120.6 | 6.4  | 21.7 | 61.0 | 0.24 | 0.64  | 127.0 | 75.0 |



HA590 Sells as Lot 90.

# 90 HA590 3/4 SM

**Heterozygous Black** Polled  
**Bull ASA #3902628** HA590 **BD: 9/22/2020**

HOOK'S BALTIC 17B GW PREDESTINED 701T  
 FC892 OGRA590  
 OGR931 SVR U295

| 365 Day Ultrasound |          |         |       |      |      |      |      |       |       |      |
|--------------------|----------|---------|-------|------|------|------|------|-------|-------|------|
| BW                 | 10/14 WW | SALE WT | SC    | ADG  | WDA  | IMF  | BF   | REA   |       |      |
| 87                 | 1104     | 1670    | 39.5  | 3.17 | 2.87 | 3.03 | 0.19 | 11.90 |       |      |
| CE                 | BW       | WW      | YW    | MCE  | MILK | MWW  | MB   | REA   | API   | TI   |
| 12.2               | 0.2      | 80.1    | 128.9 | 6.9  | 18.8 | 58.7 | 0.49 | 0.66  | 147.9 | 84.7 |

**91 HD261 5/8 SM**  
 Black Polled  
 Bull ASA #3902629 HD261 BD: 9/5/2020

FC892 HOOK'S BALTIC 17B TSN PROTEGE Z896  
 OGRD261  
 OGRC892 OGRA357

| 365 Day Ultrasound |          |         |       |      |      |      |      |       |       |      |
|--------------------|----------|---------|-------|------|------|------|------|-------|-------|------|
| BW                 | 10/14 WW | SALE WT | SC    | ADG  | WDA  | IMF  | BF   | REA   |       |      |
| 90                 | 1196     | 1569    | 39.5  | 2.98 | 2.61 | 1.66 | 0.11 | 14.63 |       |      |
| CE                 | BW       | WW      | YW    | MCE  | MILK | MWW  | MB   | REA   | API   | TI   |
| 11.1               | 0.9      | 82.3    | 130.9 | 4.7  | 13.9 | 54.9 | 0.27 | 0.71  | 132.6 | 78.9 |

**92 HC874 1/2 SM**  
 Black Polled  
 Bull ASA #4012075 HC874 BD: 10/5/2020

FC892 HOOK'S BALTIC 17B GW PREMIUM BEEF 021TS  
 OGRD261  
 OGRC892 OGRC874 OGRA600

| 365 Day Ultrasound |          |         |       |      |      |      |      |       |       |      |
|--------------------|----------|---------|-------|------|------|------|------|-------|-------|------|
| BW                 | 10/14 WW | SALE WT | SC    | ADG  | WDA  | IMF  | BF   | REA   |       |      |
| 95                 | 1180     | 1684    | 41.0  | 3.38 | 2.96 | 1.34 | 0.11 | 12.51 |       |      |
| CE                 | BW       | WW      | YW    | MCE  | MILK | MWW  | MB   | REA   | API   | TI   |
| 12.7               | -0.3     | 73.6    | 119.7 | 6.6  | 17.3 | 53.9 | 0.27 | 0.67  | 130.0 | 76.0 |

**93 HZ457 7/8 SM**  
 Black Polled  
 Bull ASA #3902627 HZ457 BD: 9/18/2020

FC892 HOOK'S BALTIC 17B TNT AXIS X307  
 SVRZ457  
 OGRC892 SPRING VALLEY P691

| 365 Day Ultrasound |          |         |       |      |      |      |      |       |       |      |
|--------------------|----------|---------|-------|------|------|------|------|-------|-------|------|
| BW                 | 10/14 WW | SALE WT | SC    | ADG  | WDA  | IMF  | BF   | REA   |       |      |
| 86                 | 1108     | 1545    | 38.0  | 3.01 | 2.63 | 2.19 | 0.18 | 11.64 |       |      |
| CE                 | BW       | WW      | YW    | MCE  | MILK | MWW  | MB   | REA   | API   | TI   |
| 9.1                | 2.1      | 82.6    | 125.4 | 5.1  | 16.6 | 57.8 | 0.20 | 0.97  | 135.5 | 80.9 |

**94 HC174 3/4 SM**  
 Black Polled/Scurred  
 Bull ASA #4015354 HC174 BD: 9/25/2020

FC892 HOOK'S BALTIC 17B OGRZT016  
 OGRD261  
 OGRC892 OGRC174 R597

| 365 Day Ultrasound |          |         |       |      |      |      |      |       |       |      |
|--------------------|----------|---------|-------|------|------|------|------|-------|-------|------|
| BW                 | 10/14 WW | SALE WT | SC    | ADG  | WDA  | IMF  | BF   | REA   |       |      |
| 89                 | 1335     | 1757    | 43.0  | 3.27 | 3.04 | 1.78 | 0.11 | 12.35 |       |      |
| CE                 | BW       | WW      | YW    | MCE  | MILK | MWW  | MB   | REA   | API   | TI   |
| 10.6               | 1.6      | 80.0    | 124.9 | 5.8  | 18.5 | 58.4 | 0.33 | 0.79  | 130.2 | 78.8 |

## Notes on Fertility

This year, our fertility testing and breeding soundness evaluation with Dr. Bjornstad went the best it ever has. Excellent test results and very few problems. Dr. Bjornstad commented that a 36 to 37 centimeter scrotal measurement is ideal for bulls this age. The official average for all Open Gate Bulls this year is 37.8. That makes us feel pretty good to know we are hitting the target for well developed bulls, ready to breed, and carrying high fertility across the board. This is a classic component that Simmental Influence will bring to a crossbreeding program. And if this kind of fertility is so measurably consistent in the bulls, we know it is present in the females too. You are buying a complete package of genetics for long term profitability. Another reason we are glad to stand behind our guarantee that our bulls will do their job.



OPEN GATE RANCH

**100 J533** *PB SM Open Heifer*

Black Polled  
 Cow ASA #4020544 J533 BD: 1/15/2021  
 BW: 84 10/15 WW: 588

CCR COWBOY CUT 5048Z OLF OTIS Y43  
 WS PROCLAMATION E202 G120  
 WS MISS SUGAR C4 OGRE506

| CE   | BW  | WW   | YW    | MCE | MILK | MWW  | MB   | REA  | API   | TI   |
|------|-----|------|-------|-----|------|------|------|------|-------|------|
| 13.1 | 1.6 | 96.3 | 145.4 | 9.3 | 31.4 | 79.0 | 0.26 | 0.90 | 152.8 | 93.4 |

**101 J658** *1/2 SM Open Heifer*

Black Polled  
 Cow ASA #4020567 J658 BD: 3/4/2021  
 BW: 89 10/15 WW: 664

MR NLC UPGRADE U8676 SITZ MADISON 10477  
 GIBBS 0601X RAISINCAIN OGRA41  
 ASR SWEET DREAMS M229 OGRN480

| CE  | BW  | WW   | YW    | MCE | MILK | MWW  | MB   | REA  | API   | TI   |
|-----|-----|------|-------|-----|------|------|------|------|-------|------|
| 9.3 | 1.7 | 79.6 | 123.4 | 4.6 | 22.7 | 62.2 | 0.21 | 0.86 | 122.6 | 76.2 |

**102 J588** *3/4 SM Open Heifer*

Black Polled  
 Cow ASA #4020580 J588 BD: 2/12/2021  
 BW: 90 10/15 WW: 668

CCR COWBOY CUT 5048Z OGRYT016  
 TJ COWBOY UP 529B OGRC129  
 TJ MS 46W SVR S695

| CE   | BW  | WW   | YW    | MCE | MILK | MWW  | MB   | REA  | API   | TI   |
|------|-----|------|-------|-----|------|------|------|------|-------|------|
| 10.3 | 2.0 | 82.3 | 123.0 | 6.7 | 18.4 | 59.7 | 0.29 | 0.58 | 135.4 | 78.1 |

**103 J664** *3/4 SM Open Heifer*

Black Polled  
 Cow ASA #4020490 J664 BD: 3/4/2021  
 BW: 78 10/15 WW: 670

MR NLC UPGRADE U8676 HOOK'S INFINITI 10U  
 TJ MAIN EVENT 503B OGRA583  
 TJ MISS NEW DAY U14 OGRU792

| CE   | BW   | WW   | YW    | MCE | MILK | MWW  | MB   | REA  | API   | TI   |
|------|------|------|-------|-----|------|------|------|------|-------|------|
| 12.8 | -0.3 | 76.6 | 116.8 | 5.0 | 22.0 | 61.0 | 0.27 | 0.84 | 136.2 | 78.3 |

**104 J660** *5/8 SM Open Heifer*

Black Polled  
 Cow ASA #4020448 J660 BD: 3/4/2021  
 BW: 86 10/15 WW: 730

MR NLC UPGRADE U8676 SV NORTHWEST FIGURE  
 TJ MAIN EVENT 503B OGRB47  
 TJ MISS NEW DAY U14 SVRZ358

| CE   | BW  | WW   | YW    | MCE | MILK | MWW  | MB   | REA  | API   | TI   |
|------|-----|------|-------|-----|------|------|------|------|-------|------|
| 11.5 | 0.7 | 82.5 | 123.2 | 5.5 | 23.8 | 64.9 | 0.24 | 0.79 | 136.8 | 79.7 |

**105 J798T** *PB SM Open Heifer*

Black Polled  
 Cow ASA #4006701 J798T BD: 2/1/2021  
 BW: 91 10/15 WW: 712

OLF OTIS Y43 HOOK'S BALTIC 17B  
 OGRDZ387 TAYLORE632  
 TAYLORZ387 SVRW679

| CE   | BW  | WW   | YW    | MCE | MILK | MWW  | MB   | REA  | API   | TI   |
|------|-----|------|-------|-----|------|------|------|------|-------|------|
| 11.1 | 2.8 | 87.2 | 133.8 | 7.6 | 21.3 | 64.8 | 0.07 | 1.03 | 120.4 | 77.0 |

**106 J814T** *3/4 SM Open Heifer*

Black Polled  
 Cow ASA #4007863 J814T BD: 2/15/2021  
 BW: 88 10/15 WW: 732

OLF OTIS Y43 CLRS CONSTITUTION 311 C  
 OGRDZ387 TAYLORF574  
 TAYLORZ387 TAYLORD514

| CE   | BW  | WW   | YW    | MCE | MILK | MWW  | MB   | REA  | API   | TI   |
|------|-----|------|-------|-----|------|------|------|------|-------|------|
| 13.2 | 1.6 | 92.6 | 146.7 | 9.4 | 24.8 | 71.1 | 0.07 | 0.89 | 131.4 | 82.2 |

**107 J783T** *PB SM Open Heifer*

Heterozygous Black Polled  
 Cow ASA #4006711 J783T BD: 1/26/2021  
 BW: 80 10/15 WW: 780

OLF OTIS Y43 WS BEEF MAKER R13  
 OGRDZ387 SVRW592  
 TAYLORZ387 SPRING VALLEY P598

| CE   | BW  | WW   | YW    | MCE | MILK | MWW  | MB   | REA  | API   | TI   |
|------|-----|------|-------|-----|------|------|------|------|-------|------|
| 12.5 | 1.5 | 83.2 | 125.9 | 9.2 | 24.9 | 66.4 | 0.10 | 1.03 | 137.3 | 81.8 |





# 108 J784T *PB SM Open Heifer*

Heterozygous Black Polled  
 Cow ASA #4006714 J784T BD: 1/26/2021  
 BW: 82 10/15 WW: 806

OLF OTIS Y43 WS BEEF MAKER R13  
 OGRDZ387 SVRW592  
 TAYLORZ387 SPRING VALLEY P598

| CE   | BW  | WW   | YW    | MCE | MILK | MWW  | MB   | REA  | API   | TI   |
|------|-----|------|-------|-----|------|------|------|------|-------|------|
| 12.5 | 1.5 | 83.2 | 125.9 | 9.2 | 24.9 | 66.4 | 0.10 | 1.03 | 137.3 | 81.8 |

# 109 J581 *3/4 SM Open Heifer*

Black Polled  
 Cow ASA #4020548 J581 BD: 2/6/2021  
 BW: 82 10/15 WW: 688

CDI REVIVAL 370D HOOK'S EASTWOOD 30C  
 CDI TRUSTEE 387F OGRF828  
 CDI MISS HOMETOWN 163C OGRY891

| CE   | BW  | WW   | YW    | MCE | MILK | MWW  | MB   | REA  | API   | TI   |
|------|-----|------|-------|-----|------|------|------|------|-------|------|
| 12.0 | 1.7 | 90.4 | 139.8 | 6.0 | 23.1 | 68.5 | 0.21 | 1.12 | 124.7 | 83.0 |

# 110 J624 *3/4 SM Open Heifer*

Black Polled  
 Cow ASA #4020470 J624 BD: 2/21/2021  
 BW: 82 10/15 WW: 732

CDI REVIVAL 370D TFS BLACK ONYX 1442Y  
 CDI TRUSTEE 387F OGRB604  
 CDI MISS HOMETOWN 163C OGRZ971

| CE   | BW  | WW   | YW    | MCE | MILK | MWW  | MB   | REA  | API   | TI   |
|------|-----|------|-------|-----|------|------|------|------|-------|------|
| 11.8 | 0.7 | 81.6 | 121.4 | 6.4 | 21.9 | 63.1 | 0.12 | 0.99 | 130.3 | 76.4 |

# 111 J626 *1/2 SM Open Heifer*

Heterozygous Black Polled  
 Cow ASA #4020581 J626 BD: 2/21/2021  
 BW: 95 10/15 WW: 702

MCM TOP GRADE 018X BECKTON EPIC R397 K  
 HOOK'S BOUNTY 6B OGRC883  
 HOOK'S YUMA 49Y OGRA590

| CE  | BW  | WW   | YW    | MCE | MILK | MWW  | MB   | REA  | API   | TI   |
|-----|-----|------|-------|-----|------|------|------|------|-------|------|
| 9.3 | 1.4 | 79.7 | 129.4 | 6.7 | 30.6 | 70.3 | 0.36 | 0.75 | 143.0 | 80.6 |

# 112 J625 *1/2 SM Open Heifer*

Black Polled  
 Cow ASA #4020554 J625 BD: 2/21/2021  
 BW: 83 10/15 WW: 710

CONNELLY STIMULUS 8419 ELLINGSON LEGACY M229  
 CONNEALY SPUR OGRA526  
 JAZZA OF CONANGA 8594 OGRU787

| CE   | BW   | WW   | YW    | MCE | MILK | MWW  | MB   | REA  | API   | TI   |
|------|------|------|-------|-----|------|------|------|------|-------|------|
| 13.4 | -0.2 | 73.5 | 115.3 | 7.8 | 19.4 | 56.3 | 0.38 | 0.59 | 141.9 | 77.6 |

# 113 J567 *3/8 SM Open Heifer*

Black Polled  
 Cow ASA #4020454 J567 BD: 2/1/2021  
 BW: 83 10/15 WW: 712

S A V RESOURCE 1441 HOOK'S BALTIC 17B  
 S A V TERRITORY 7225 OGRE621  
 S A V EMBLYNETTE 3293 OGRY891

| CE   | BW  | WW   | YW    | MCE | MILK | MWW  | MB   | REA  | API   | TI   |
|------|-----|------|-------|-----|------|------|------|------|-------|------|
| 12.3 | 0.7 | 87.5 | 147.7 | 5.2 | 15.7 | 59.6 | 0.37 | 0.71 | 131.4 | 83.3 |

# 114 J810T *5/8 SM Open Heifer*

Black Polled  
 Cow ASA #4006707 J810T BD: 2/6/2021  
 BW: 86 10/15 WW: 716

GAR-EGL PROTEGE HSR RED MAGNUM C708  
 TSN PROTEGE Z896 OGRF829  
 TSN MISS FORCE U690 OGRZ4221

| CE   | BW  | WW   | YW    | MCE | MILK | MWW  | MB   | REA  | API   | TI   |
|------|-----|------|-------|-----|------|------|------|------|-------|------|
| 12.2 | 0.3 | 86.0 | 136.1 | 6.0 | 13.9 | 56.8 | 0.24 | 0.77 | 134.9 | 82.0 |

# 115 J782T *3/4 SM Open Heifer*

Black Polled  
 Cow ASA #4007820 J782T BD: 1/26/2021  
 BW: 83 10/15 WW: 818

CCR COWBOY CUT 5048Z CONNEALY SPUR  
 WS PROCLAMATION E202 G635T  
 WS MISS SUGAR C4 TAYLORB448

| CE   | BW  | WW   | YW    | MCE | MILK | MWW  | MB   | REA  | API   | TI   |
|------|-----|------|-------|-----|------|------|------|------|-------|------|
| 11.8 | 1.3 | 94.8 | 143.1 | 7.1 | 31.0 | 78.4 | 0.54 | 0.81 | 153.4 | 94.7 |



**116 J787T** *1/2 SM Open Heifer*

Red Polled  
 Cow ASA #4006697 J787T BD: 1/27/2021  
 BW: 80 10/15 WW: 764

BIEBER SPARTACUS A193 HSR RED MAGNUM C708  
 BIEBER GLADIATOR C386 OGRF736  
 BIEBER LAURA 158W OGR C875

| CE   | BW   | WW   | YW    | MCE | MILK | MWW  | MB   | REA  | API   | TI   |
|------|------|------|-------|-----|------|------|------|------|-------|------|
| 14.8 | -2.4 | 76.0 | 123.7 | 7.3 | 23.2 | 61.1 | 0.52 | 0.62 | 135.8 | 86.1 |

**117 J791T** *1/2 SM Open Heifer*

Red Polled  
 Cow ASA #4007864 J791T BD: 1/30/2021  
 BW: 86 10/15 WW: 716

HOOKS TRINITY 9T BROWN BLW STATISTICIAN B5240  
 LEACHMAN CADILLAC L025A TAYLORE556  
 REMPE STABILIZER YD032 TAYLORE556

| CE   | BW   | WW   | YW    | MCE | MILK | MWW  | MB   | REA  | API   | TI   |
|------|------|------|-------|-----|------|------|------|------|-------|------|
| 13.1 | -0.2 | 80.0 | 129.8 | 6.3 | 28.6 | 68.6 | 0.29 | 0.67 | 128.1 | 80.2 |

**118 J775T** *1/2 SM Open Heifer*

Red Polled  
 Cow ASA #4007736 J775T BD: 1/21/2021  
 BW: 88 10/15 WW: 740

BROWN 3K STAKEHOLDER X7870 TAYLORAW595 AXEL  
 FW294 TAYLORE538  
 TAYLORW294 TAYLORB443

| CE   | BW  | WW   | YW    | MCE | MILK | MWW  | MB   | REA  | API   | TI   |
|------|-----|------|-------|-----|------|------|------|------|-------|------|
| 11.2 | 1.0 | 84.2 | 131.1 | 7.0 | 22.7 | 64.8 | 0.35 | 0.64 | 132.0 | 81.7 |

**119 J779T** *1/4 SM Open Heifer*

Red Polled  
 Cow ASA #4007857 J779T BD: 1/24/2021  
 BW: 86 10/15 WW: 764

WFL MERLIN 018A BROWN 3K STAKEHOLDER X7870  
 WFL PROFITMAKER E7030 TAYLORF578  
 WFL PROSPECT TAYLORY349

| CE   | BW   | WW   | YW    | MCE | MILK | MWW  | MB   | REA  | API   | TI   |
|------|------|------|-------|-----|------|------|------|------|-------|------|
| 13.0 | -1.5 | 81.1 | 126.5 | 6.5 | 25.7 | 66.2 | 0.35 | 0.35 | 135.8 | 82.8 |

**120-122 COMMERCIAL** *Open Heifers*





Your only locally owned & operated livestock video auction with an extensive national buyer base.

As we enter on the 18th year of business, we invite you to market your cattle and sheep with us as one of the leading marketing firms in the nation. As a consignor or a buyer you will like our way of doing business.

### 2022 Sale Schedule

|                      |              |
|----------------------|--------------|
| Early Summer Special | June 23-24   |
| Summertime Classic   | July 18-20   |
| Early Fall Preview   | August 22-23 |
| Fall Premier Special | September 19 |

Plan to use our new **Northern Weekly Timed Online Auctions** late September through early June.

Call for details (866) 616-5035 or go to **[northernlivestockvideo.com](http://northernlivestockvideo.com)**



HOME OF THE  
**NORTHERN  
& GOLD**  
PROGRAM

### SALE COORDINATORS

Joe Goggins      Ty Thompson      Bill Cook  
(406) 861-5664      (406) 698-4783      (406) 670-0689

OPEN GATE RANCH

121 8th Lane SW  
Fairfield, MT 59436

Presorted  
First Class  
US Postage  
**PAID**  
SlateGroup



# Open Gate Ranch

## 42<sup>nd</sup> Annual Bull Sale

**Thursday, March 31, 2022**

**1:00 pm • Simms, MT**

At Broken O Land and Livestock

**Simmental. SimAngus. BUILD BETTER BEEF.**