

Open Gate Ranch

44th Annual Bull Sale



Friday, March 29, 2024

1:00 pm • Augusta, MT

At Broken O Land and Livestock

Simmental. SimAngus. BUILD BETTER BEEF.

Notes on Reading our Sale Book...



When we sort through the stacks of Bull Sale Books we receive each year, we notice everyone presents their data a bit differently. Surely, this can get confusing-but it's important to remember there is no right or wrong formula to building a catalog. We choose to present the data that is most relevant to the way we make breeding decisions, the way we manage our cattle, and the trends we want to be able to track and observe in each year's calf crop.

For example, we like to think of our cattle in simple, straightforward terms, that we can actually keep straight mentally and visualize. So we don't include as many EPDs as we could. We monitor our trends on all of the traits and understand their merit, but we strive to effect change according to what most of our customers need. So a simpler data set works well for us. We continue to provide actual records of ultrasound, gain, and birthweight, because we like to see whether traits are truly manifesting themselves - if the patterns in a sire group show that genetic markers have actually triggered and are doing what they promise. Large discrepancies or inconsistencies in a sire group are a red flag to us and will influence our decision of whether to use a sire again.

So please don't hesitate to reach out to one of us if you do not see data you need, or if it is unclear why we include it. We would love to help you utilize better the patterns we see when we put it together every year.

Sale Location

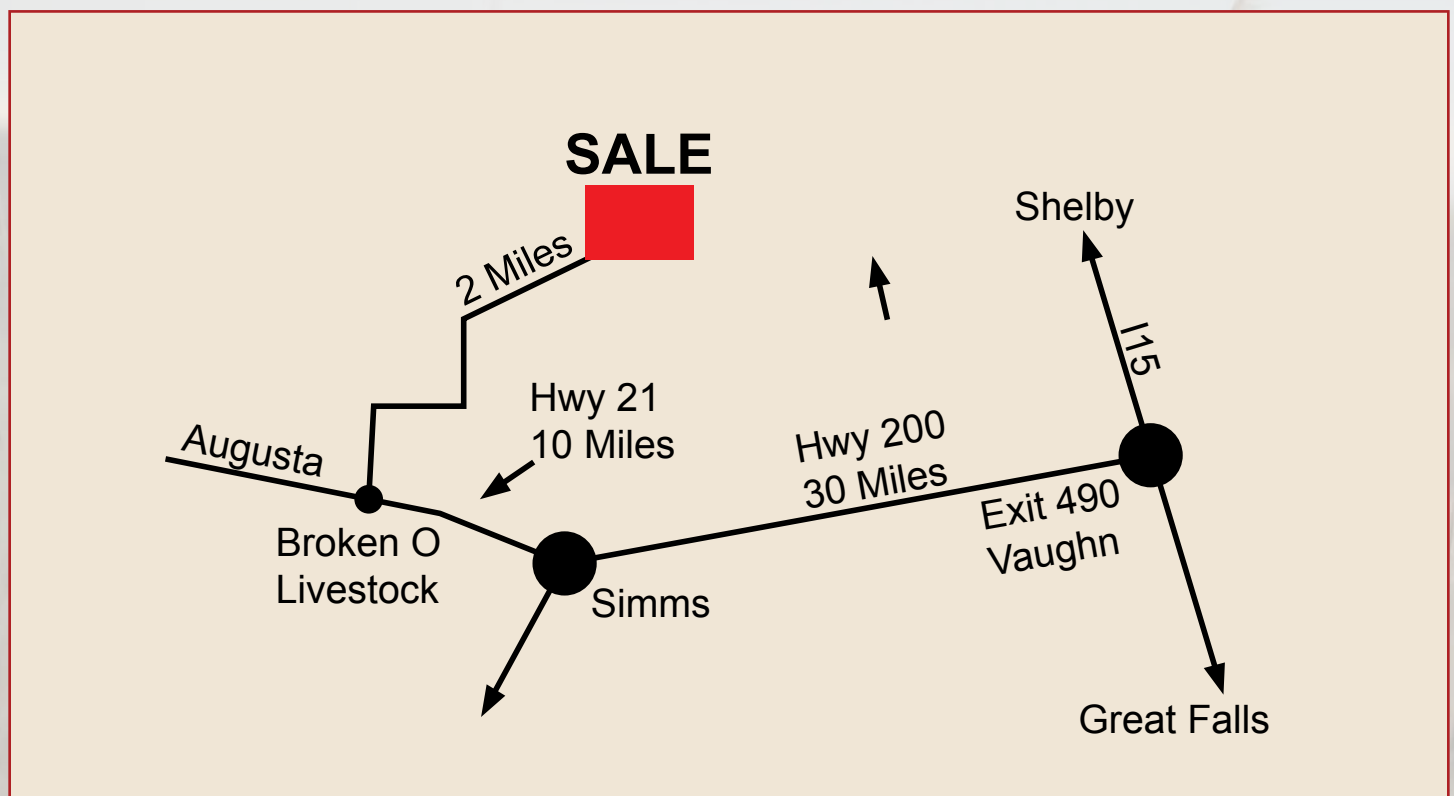

Open Gate Ranch

Friday, March 29, 2024

1:00 pm • Augusta, MT

At Broken O Land and Livestock

SCHEDULE OF EVENTS

FRIDAY, MARCH 29

All Day Cattle available for viewing
Come early for coffee and to see the bulls.

12:00 NOON Lunch

1:00 PM **OPEN GATE RANCH BULL SALE**

SALE LOCATION

Broken O Land and Livestock is located ten miles west of Simms, MT on Highway 21. For map and directions, see opposite page.

AUCTIONEER

Roger Jacobs

LIVESTOCK PRESS REPRESENTATIVES

John Goggins, *Western Ag Reporter*

Jeff Thomas, *Lee Agri Media*

Devin Murnin, *Western Livestock Journal*

SEMEN INTEREST

Open Gate Ranch reserves the right to collect semen for our personal use on any of the bulls offered in the sale. This will be done outside the breeding season at our expense.

SATISFACTION GUARANTEED

Open Gate Ranch offers a **COMPLETE SATISFACTION AND SOUNDNESS GUARANTEE** up to the second breeding season on every bull purchased at our sale. This includes bull replacement or full credit minus salvage against a new one. Please notify one of us immediately if any problem develops. We truly want to be the first to know.

Any individual purchasing **3 OR MORE BULLS WILL RECEIVE A 5% VOLUME DISCOUNT** off the purchase price.

There is **\$100 DISCOUNT PER BULL FOR HAULING** your own on sale day.

Buyers unable to attend the sale can **PURCHASE BULLS SIGHT UNSEEN** and know that when we deliver them - if you don't like them, you don't own them. Please contact us ahead of time if you would like to bid by proxy or by phone.

SALE DAY PHONE 406-264-5926

FAMILY PHONES:

Mike and Kim 467-2082 • Julie 590-4063 • Micah 590-1609

Dustin 590-6016

www.OPENGATERANCH.COM

ABOUT THE BULLS

The bulls are available for viewing at the ranch prior to the sale. They are located in the development pasture near the ranch. From Fairfield, take Hwy 408 west for 9.5 miles, turn north onto the gravel, top the big hill, 3/4 of a mile further the and the bulls are on the right.

Videos of the bulls available online www.opengateranch.com

EPDS on both sale bulls and Reference Sires are printed as calculated by American Simmental Association and follow the Simmental definition for each trait.

ULTRASOUND SCAN DATA was taken on 2/29/2024 by Sonya Gregory and interpreted at a Central Ultrasound Processing Lab. It is an actual calculation of each bull's carcass information that has been adjusted to a 365 day measurement, which will facilitate accurate comparison between bulls. American Simmental Association provided updated Carcass EPDs based on the scan data. IMF is marbling as a percent of mass, BF is back fat in percent of inch, and REA is rib eye in square inches. Ultrasound data available sale day.

SCROTAL EVALUATION AND FERTILITY TESTING was done by Dr. Cale Bjornstad on 2/22/2024.

BID LIVE ONLINE

Sale will be live online
northernlivestockvideo.com



ALLIED
GENETIC RESOURCES

Marty Ropp 406-581-7835

Rocky Forseth 406-590-7984

Jared Murnin 406-321-1542

www.alliedgeneticresources.com

WELCOME TO THE SALE



Nothing is more expensive than a *missed opportunity*

That great shift in the Beef Business that we talked about all last year, and have seen rolling out in every sector of sales, is a strong reality now. We are experiencing the tipping of profits back toward the cattleman, and the luxury of being in the driver's seat of our marketing decisions.

The industry analysts and professionals who make it their business and their work to study, spin and distill down OUR business and OUR work are all asking one big, looming question- "What are we planning to do about rebuilding the nation's Beef herds?"

There are plenty of people in the Beef Business right now wishing that 2 years ago they had retained or purchased as many heifers as they could get their hands on. Oh, for the crystal ball, the scoop, the inside track . . .

However, there are other, more meaningful ways to take advantage of an opportunity than simply increasing the cow herd. Many of us are in the reality of having a set land and resource base, with neither the space nor the labor to run more cows. So, if we're going to play it smart, what are our options? Some food for thought:

- we build our females with capacity: full bodied and solid, enabling the same resource base to be adequate to a highly productive herd
- we pay sufficient attention to carcass quality: both marbling AND YIELD, to avoid waste and keep consumer demand high
- we acknowledge that heavy calves are worth more than fat calves and learn to pay attention to muscle mass and how it is expressed in the genetics we purchase
- we continue to harness the powerful advantages of cross-breeding to capture maximum pounds and value out of exactly the same cows

Our Sale features large sire groups this year, each with their own strengths and styles. As you begin to make selections from the offering, we encourage you not just to look for what is familiar to you, but to also think about COMPLEMENTARITY. Take an honest look at the dominant characteristics of your cow base and ask yourself what is needed to make them even more complete. If we all stay keenly committed to the opportunity of investing in true genetic merit that is tuned to our own environment, then we will emerge from this heady cycle of high cash values prepared to weather anything that comes next. We will have rebuilt the nation's Beef herds, and rebuilt them better than ever.

Very excited to see you all at the end of the month! Our data in the Sale Book is not as complete as usual. You will find ultrasound results and their accompanying EPD adjustment values in a supplement sheet on Sale Day.

Please accept our warm greetings and best wishes for the remainder of your calving season.

Stay safe, keep at it.
The Open Gate Crew

HOOK'S EAGLE 6E

In his fifth year of siring an impeccable genetic profile that adds value to every segment, this attractive combination of performance and carcass quality is proving consistent, measurable, and versatile. You will notice that our group looks like a matched set, and they have all the way through.



HOOK'S EAGLE 6E Reference Sire.

HOOK'S EAGLE 6E

3/4 SM 1/4 AN Bull ASA #3253742

SIRE: HOOK'S BLACK HAWK 50B

MGS: GW-WBF SUBSTANCE 820Y

CE	BW	WW	YW	MCE	MILK	MWW	MARB	REA	\$API	\$TI
14.4	-2.1	98.9	155.0	4.7	20.4	69.7	0.60	1.38	168.1	104.1

Bulls to sire OPPORTUNITY!

1 LG125 3/4 SM

Black Polled
Bull ASA #4311903 LG125 BD: 1/26/2023

HOOK'S BLACK HAWK 50B OLF OTIS Y43
HOOK'S EAGLE 6E G125
HOOK'S CRYSTAL 1C OGRB481

BW	10/22 WW	SALE WT	SC	ADG
87	962	1490	39.0	3.39

CE	BW	WW	YW	MCE	MILK	MWW	MB	REA	API	TI
13.6	-0.3	97.2	151.1	6.9	25.0	73.5	0.32	1.03	151.8	93.7

2 LJ621 1/2 SM

Black Polled
Bull ASA #4311885 LJ621 BD: 1/9/2023

HOOK'S BLACK HAWK 50B S A V TERRITORY 7225
HOOK'S EAGLE 6E J621
HOOK'S CRYSTAL 1C OGRB992

BW	10/22 WW	SALE WT	SC	ADG
87	956	1490	37.0	3.09

CE	BW	WW	YW	MCE	MILK	MWW	MB	REA	API	TI
11.9	0.7	99.0	154.3	5.2	22.1	72.0	0.46	1.06	146.4	95.2

3 LH439 3/4 SM

Black Polled
Bull ASA #4311980 LH439 BD: 1/20/2023

HOOK'S BLACK HAWK 50B WS PROCLAMATION E202
HOOK'S EAGLE 6E H439
HOOK'S CRYSTAL 1C OGRB617

BW	10/22 WW	SALE WT	SC	ADG
71	890	1435	39.0	3.05

CE	BW	WW	YW	MCE	MILK	MWW	MB	REA	API	TI
15.0	-2.6	88.6	136.7	6.8	23.6	67.8	0.64	0.98	166.9	99.1



LH439 Sells as Lot 3.



4 LG342 3/4 SM

Black Polled
 Bull ASA #4311999 LG342 BD: 1/25/2023

HOOK'S BLACK HAWK 50B GIBBS 0601X RAISINCAIN
 HOOK'S EAGLE 6E G342
 HOOK'S CRYSTAL 1C OGRX270

BW	10/22 WW	SALE WT	SC	ADG						
85	824	1380	37.0	3.77						
CE	BW	WW	YW	MCE	MILK	MWW	MB	REA	API	TI
12.4	-0.3	86.1	135.2	5.9	21.7	64.6	0.38	1.08	144.6	88.8

5 LG218 3/4 SM

Black Polled
 Bull ASA #4311930 LG218 BD: 1/27/2023

HOOK'S BLACK HAWK 50B GIBBS 0601X RAISINCAIN
 HOOK'S EAGLE 6E G218
 HOOK'S CRYSTAL 1C OGRA546

BW	10/22 WW	SALE WT	SC	ADG						
87	860	1440	38.0	3.32						
CE	BW	WW	YW	MCE	MILK	MWW	MB	REA	API	TI
12.0	-0.1	84.6	130.0	5.5	22.2	64.3	0.42	1.02	143.8	87.9

6 LH440 1/2 SM

Black Polled
 Bull ASA #4319705 LH440 BD: 1/19/2023

HOOK'S BLACK HAWK 50B CONNEALY SPUR
 HOOK'S EAGLE 6E OGRH440
 HOOK'S CRYSTAL 1C OGRX848

BW	10/22 WW	SALE WT	SC	ADG						
83	846	1420	37.0	3.35						
CE	BW	WW	YW	MCE	MILK	MWW	MB	REA	API	TI
12.8	-0.1	90.1	143.2	5.7	25.1	69.9	0.60	0.98	153.7	94.7

7 LH327 3/4 SM

Black Polled
 Bull ASA #4319703 LH327 BD: 1/27/2023

HOOK'S BLACK HAWK 50B GY303
 HOOK'S EAGLE 6E OGRH327
 HOOK'S CRYSTAL 1C OGRD75

BW	10/22 WW	SALE WT	SC	ADG						
87	888	1425	35.5	3.85						
CE	BW	WW	YW	MCE	MILK	MWW	MB	REA	API	TI
11.1	1.1	94.4	148.0	4.9	22.1	69.2	0.34	1.17	137.9	90.7

8 LH487 5/8 SM

Black Polled
 Bull ASA #4319707 LH487 BD: 1/20/2023

HOOK'S BLACK HAWK 50B
 HOOK'S EAGLE 6E OGRH487
 HOOK'S CRYSTAL 1C OGRX737

BW	10/22 WW	SALE WT	SC	ADG						
81	960	1285	36.4	3.10						
CE	BW	WW	YW	MCE	MILK	MWW	MB	REA	API	TI
14.6	-1.3	80.9	125.5	6.7	21.2	61.6	0.44	0.90	143.7	87.8

9 LH506 3/4 SM

Black Polled
Bull ASA #4319708 LH506 BD: 1/16/2023

HOOK'S BLACK HAWK 50B WS PROCLAMATION E202
HOOK'S EAGLE 6E OGRH506
HOOK'S CRYSTAL 1C OGRE646

BW	10/22 WW	SALE WT	SC	ADG						
81	866	1375	37.5	3.40						
CE	BW	WW	YW	MCE	MILK	MWW	MB	REA	API	TI
12.8	-0.2	92.8	142.4	5.5	23.5	69.8	0.49	1.09	152.5	95.0



LH506 Sells as Lot 9.

10 LJ563 1/2 SM

Black Polled
Bull ASA #4319709 LJ563 BD: 1/5/2023

HOOK'S BLACK HAWK 50B S A V TERRITORY 7225
HOOK'S EAGLE 6E OGRJ563
HOOK'S CRYSTAL 1C OGRE562

BW	10/22 WW	SALE WT	SC	ADG						
75	976	1335	39.0	2.38						
CE	BW	WW	YW	MCE	MILK	MWW	MB	REA	API	TI
12.7	-1.2	90.8	144.2	5.5	22.1	67.9	0.42	1.05	145.4	91.7

11 LG165 5/8 SM

Black Polled
Bull ASA #4268636 LG165 BD: 1/20/2023

HOOK'S BLACK HAWK 50B HOOK'S CAPITALIST 37C
HOOK'S EAGLE 6E G165
HOOK'S CRYSTAL 1C OGRY823

BW	10/22 WW	SALE WT	SC	ADG						
87	900	1345	38.0	3.52						
CE	BW	WW	YW	MCE	MILK	MWW	MB	REA	API	TI
13.8	-1.4	81.6	128.5	6.1	22.1	62.5	0.60	0.97	160.4	92.2

FRIESEN
"Balanced Livestock Nutrition"

PROVETA
Nutrition Ltd.

Feeds Open Gate's Cattle

BRASS Formulated to provide nutrients for cattle at all stages of production.

JADE Formulated for first calf heifers and cows during late gestation through peak lactation to support dam and calf health

SAPPHIRE Formulated to provide nutrients to naive calves to support immune development and prevent malnourishment during stressful situations.

AMBER Free choice mineral with high magnesium concentration to prevent grass tentany in the spring months when forages are at their highest quality.

We pride ourselves on providing the best service for our customers based on the needs of their operation. Our year-round supplementation programs provide nutrients to gestating and lactating heifers and cows, growing cattle, bulls, and naive calves. Our services include nutritional consultations, forage testing, and diet formulations. Your herd's health, efficiency, and productivity are our main priorities!

imPact
Beef Mineral Program

integrator
beef
formulated with
Elanco
Rumensin.



Call today for a free nutritional consultation!

Dr. Cathy Lockard, Livestock Nutritionist
Call/Text: 406-799-1030
Dixon Scott, Sales Specialist
Call/Text: 406-899-3697
Office Call: 406-452-5633



Toll Free: 1-866-8-P7R73649



friesennutrition.com

POSS RAWHIDE

Standing out by progeny data and by popularity, he is siring consistency in growth, practical calving ease and carcass merit. Daughters sport an imposing, broody body style from his impressive phenotype and a powerfully stacked maternal heritage.



POSS RAWHIDE Reference Sire.

POSS RAWHIDE

PB AN Bull ASA #3876177

SIRE: POSS MAVERICK

MGS: POSS EASY IMPACT 0119

CE	BW	WW	YW	MCE	MILK	MWW	MARB	REA	\$API	\$TI
16.6	-2.1	102.1	161.9	10.8	29.5	81.0	0.88	0.46	157.1	99.8

Bulls to sire OPPORTUNITY!

12 LJ536 7/16 SM

Black Polled
Bull ASA #4311982 LJ536 BD: 1/24/2023

POSS MAVERICK WS PROCLAMATION E202
POSS RAWHIDE J536
POSS BLUEBLOOD 6502 G131

BW	10/22 WW	SALE WT	SC	ADG
86	908	1420	38.0	3.56

CE	BW	WW	YW	MCE	MILK	MWW	MB	REA	API	TI
13.9	0.4	102.0	159.2	9.2	27.5	78.9	0.61	0.59	153.9	100.3

13 LC952 1/4 SM

Black Polled
Bull ASA #4311968 LC952 BD: 2/4/2023

POSS MAVERICK W/C UNITED 956Y
POSS RAWHIDE OGRC952
POSS BLUEBLOOD 6502 SVR U295

BW	10/22 WW	SALE WT	SC	ADG
90	982	1485	38.0	2.95

CE	BW	WW	YW	MCE	MILK	MWW	MB	REA	API	TI
12.1	0.7	102.4	164.8	7.9	27.3	79.0	0.53	0.69	145.1	98.1



LJ538 Sells as Lot 14.

14 LJ538 1/2 SM

Black Polled
Bull ASA #4311983 LJ538 BD: 1/16/2023

POSS MAVERICK WS PROCLAMATION E202
POSS RAWHIDE J538
POSS BLUEBLOOD 6502 G158

BW	10/22 WW	SALE WT	SC	ADG
84	946	1525	39.0	3.53

CE	BW	WW	YW	MCE	MILK	MWW	MB	REA	API	TI
13.3	0.3	103.5	160.8	8.5	29.3	81.2	0.67	0.68	157.1	103.3

15 LH334 3/8 SM

Black Polled
Bull ASA #4311975 LH334 BD: 1/6/2023

POSS MAVERICK FC892
POSS RAWHIDE H334
POSS BLUEBLOOD 6502 OGRD207

BW	10/22 WW	SALE WT	SC	ADG
85	970	1610	41.0	3.76

CE	BW	WW	YW	MCE	MILK	MWW	MB	REA	API	TI
13.9	0.9	103.4	164.7	8.6	27.4	79.6	0.54	0.72	151.1	99.3

16 LJ553 1/4 SM

Black Scurred
Bull ASA #4311984 LJ553 BD: 1/24/2023

POSS MAVERICK
POSS RAWHIDE J553
POSS BLUEBLOOD 6502 G136

BW	10/22 WW	SALE WT	SC	ADG
87	970	1490	38.5	3.19

CE	BW	WW	YW	MCE	MILK	MWW	MB	REA	API	TI
13.6	0.8	100.5	157.2	8.6	28.8	79.5	0.51	0.59	140.8	96.7

17 LJ610 7/16 SM

Black Polled
Bull ASA #4311909 LJ610 BD: 1/18/2023

POSS MAVERICK CDI TRUSTEE 387F
POSS RAWHIDE J610
POSS BLUEBLOOD 6502 OGRA562

BW	10/22 WW	SALE WT	SC	ADG
83	956	1460	39.5	3.04

CE	BW	WW	YW	MCE	MILK	MWW	MB	REA	API	TI
13.2	0.6	99.9	155.5	7.2	27.0	77.4	0.59	0.81	150.1	98.8



LJ610 Sells as Lot 17.



LY30 Sells as Lot 19.

18 LH401 1/4 SM

Black Polled
Bull ASA #4311978 LH401 BD: 1/16/2023

POSS MAVERICK WS PROCLAMATION E202
POSS RAWHIDE H401
POSS BLUEBLOOD 6502 OGRE538

BW	10/22 WW	SALE WT	SC	ADG
82	916	1450	36.5	3.35

CE	BW	WW	YW	MCE	MILK	MWW	MB	REA	API	TI
14.9	-0.7	95.6	150.5	9.2	26.6	75.0	0.66	0.49	156.4	98.9

19 LY30 1/4 SM

Black Polled
Bull ASA #4312008 LY30 BD: 2/7/2023

POSS MAVERICK CDI TRUMP FORCE 156W
POSS RAWHIDE SVRY30
POSS BLUEBLOOD 6502 SVR U119

BW	10/22 WW	SALE WT	SC	ADG
90	1005	1575	41.5	3.63

CE	BW	WW	YW	MCE	MILK	MWW	MB	REA	API	TI
12.0	0.3	97.6	154.5	7.8	26.5	75.8	0.64	0.77	151.6	98.5

20 LJ630 3/8 SM

Black Polled
Bull ASA #4311985 LJ630 BD: 1/16/2023

POSS MAVERICK CDI TRUSTEE 387F
POSS RAWHIDE J630
POSS BLUEBLOOD 6502 OGR907

BW	10/22 WW	SALE WT	SC	ADG
88	886	1370	36.0	2.91

CE	BW	WW	YW	MCE	MILK	MWW	MB	REA	API	TI
13.4	0.2	96.0	151.7	7.4	24.2	72.6	0.59	0.74	152.0	96.6



LJ571 Sells as Lot 21.

21 LJ571 1/2 SM

Black Polled
Bull ASA #4311901 LJ571 BD: 1/13/2023

POSS MAVERICK GIBBS 0601X RAISINCAIN
POSS RAWHIDE J571
POSS BLUEBLOOD 6502 OGRE475

BW	10/22 WW	SALE WT	SC	ADG						
82	1035	1535	40.0	3.91						
CE	BW	WW	YW	MCE	MILK	MWW	MB	REA	API	TI
12.4	0.7	108.0	167.6	8.6	29.4	83.8	0.61	0.81	151.9	104.1



LH328 Sells as Lot 22.

22 LH328 1/2 SM

Black Polled
Bull ASA #4311974 LH328 BD: 1/16/2023

POSS MAVERICK FC892
POSS RAWHIDE H328
POSS BLUEBLOOD 6502 A415

BW	10/22 WW	SALE WT	SC	ADG						
85	926	1510	38.5	3.49						
CE	BW	WW	YW	MCE	MILK	MWW	MB	REA	API	TI
13.2	0.6	96.9	152.2	7.9	26.8	75.7	0.61	0.75	150.8	97.2

23 LJ535 7/16 SM

Black Polled
Bull ASA #4268635 LJ535 BD: 1/7/2023

POSS MAVERICK WS PROCLAMATION E202
POSS RAWHIDE J535
POSS BLUEBLOOD 6502 F995

BW	10/22 WW	SALE WT	SC	ADG						
73	958	1455	38.5	3.34						
CE	BW	WW	YW	MCE	MILK	MWW	MB	REA	API	TI
14.4	-1.3	99.6	154.6	8.8	30.4	80.7	0.66	0.65	160.4	102.5

24 LG330 PB AN SM

Black Polled
Bull ASA #4311997 LG330 BD: 1/24/2023

POSS MAVERICK OGRG330
POSS RAWHIDE
POSS BLUEBLOOD 6502

BW	10/22 WW	SALE WT	SC	ADG						
84	866	1440	38.0	3.35						
CE	BW	WW	YW	MCE	MILK	MWW	MB	REA	API	TI
13.3	-0.2	86.5	136.4	8.3	25.0	68.8	0.71	0.38	124.6	83.3



25 LJ570 1/4 SM

Black Polled
Bull ASA #4311877 LJ570 BD: 1/27/2023

POSS MAVERICK QHF WWA BLACK ONYX 5Q11
POSS RAWHIDE J570
POSS BLUEBLOOD 6502 OGRF888

BW	10/22 WW	SALE WT	SC	ADG						
80	732	1235	35.0	2.90						
CE	BW	WW	YW	MCE	MILK	MWW	MB	REA	API	TI
14.6	-1.4	83.5	135.1	9.3	26.1	68.0	0.73	0.45	153.7	93.9

26 LJ670 7/16 SM

Black Polled
Bull ASA #4311918 LJ670 BD: 1/5/2023

POSS MAVERICK BLACK SHAMROCK E157
POSS RAWHIDE J670
POSS BLUEBLOOD 6502 OGRA459

BW	10/22 WW	SALE WT	SC	ADG						
72	858	1405	40.5	2.58						
CE	BW	WW	YW	MCE	MILK	MWW	MB	REA	API	TI
12.6	-1.1	80.8	124.3	8.6	29.7	70.6	0.58	0.64	145.9	88.9



LJ670 Sells as Lot 26.

27 LH207 1/4 SM

Black Polled
Bull ASA #4319701 LH207 BD: 1/22/2023

POSS MAVERICK GY303
POSS RAWHIDE OGRH207
POSS BLUEBLOOD 6502

BW	10/22 WW	SALE WT	SC	ADG						
85	818	1370	39.0	3.60						
CE	BW	WW	YW	MCE	MILK	MWW	MB	REA	API	TI
12.5	0.5	91.8	143.1	7.9	26.5	72.9	0.60	0.59	139.6	93.7

28 LH322 1/2 SM

Black Polled
Bull ASA #4319702 LH322 BD: 1/26/2023

POSS MAVERICK GY303
POSS RAWHIDE OGRH322
POSS BLUEBLOOD 6502 SVRX694

BW	10/22 WW	SALE WT	SC	ADG						
78	808	1280	39.0	2.76						
CE	BW	WW	YW	MCE	MILK	MWW	MB	REA	API	TI
12.7	-0.4	89.6	141.2	7.9	27.8	73.0	0.54	0.71	144.5	92.6



LH321 Sells as Lot 30.

29 LH343 3/8 SM

Black Polled
Bull ASA #4319704 LH343 BD: 1/27/2023

POSS MAVERICK GY303
POSS RAWHIDE OGRH343
POSS BLUEBLOOD 6502 OGRC842

BW	10/22 WW	SALE WT	SC	ADG						
86	830	1420	40.0	3.41						
CE	BW	WW	YW	MCE	MILK	MWW	MB	REA	API	TI
12.5	0.8	94.5	147.5	7.7	25.9	73.7	0.56	0.70	142.4	94.4

30 LH321 5/16 SM

Black Polled
Bull ASA #4319706 LH321 BD: 1/24/2023

POSS MAVERICK GY303
POSS RAWHIDE OGRH321
POSS BLUEBLOOD 6502 OGRC836

BW	10/22 WW	SALE WT	SC	ADG						
75	916	1465	37.5	3.34						
CE	BW	WW	YW	MCE	MILK	MWW	MB	REA	API	TI
12.8	-0.7	92.5	145.6	8.0	27.5	74.2	0.57	0.70	145.5	95.2

31 LJ537 1/2 SM

Black Polled
Bull ASA #4311872 LJ537 BD: 2/10/2023

POSS MAVERICK WS PROCLAMATION E202
POSS RAWHIDE J537
POSS BLUEBLOOD 6502 G124

BW	10/22 WW	SALE WT	SC	ADG						
80	848	1295	41.0	2.94						
CE	BW	WW	YW	MCE	MILK	MWW	MB	REA	API	TI
14.7	-0.8	95.8	150.2	9.2	25.7	74.0	0.57	0.60	155.1	97.3



LA523 Sells as Lot 32.

32 LA523 1/8 SM

Black Polled
 Bull ASA #4311960 LA523 BD: 2/10/2023

POSS MAVERICK TFS BLACK ONYX 1442Y
 POSS RAWHIDE A523
 POSS BLUEBLOOD 6502 X23

BW	10/22 WW	SALE WT	SC	ADG						
85	812	1340	38.0	3.21						
CE	BW	WW	YW	MCE	MILK	MWW	MB	REA	API	TI
14.1	-1.2	77.5	122.2	9.2	26.4	65.6	0.56	0.27	165.9	100.2

Postcard from the Feedyard We've just rolled into our second year of retaining ownership of our feeder heifers. We won't pretend it wasn't a seriously intimidating step. The risk, the crossover of forgoing the Fall cash flow and investing more cost into our market animals, and facing the reality of an actual report card on genetic merit and EPD expression.

Two things propelled us toward the move: we were tired of accepting such a huge discount for our heifer mates, bred exactly the same as the steers and with just as much ability to perform and grade- and, we were seeking a way to get real time carcass data on the sire selections we make and the progeny we offer in our Production Sale.

Our Keys to Success so far? We partnered with a savvy lender, who has helped us to evaluate our budget projections and bridge the gap to a much longer marketing target. Most critically, we partnered with Butterfield Feedyards, a family of farmer/feeders in Atkinson, Nebraska who raise cattle similar to our own, have made a tremendous success of feeding them, and are willing to maintain a very transparent business and communication relationship with us. We are not too small for them to give us relevant and meaningful feedback, provide guidance, and offer an open door policy for seeing their operation and our cattle on feed. It has been an exhilarating and nail-biting learning curve, but one long overdue.



BCLR MANIFESTO G352

Deep and expressively muscled, he boasts perfect foot structure with flex and correct movement. He raises the bar higher than his sire's in capacity and structural soundness and brings a long legacy of maternal excellence to the package.



BCLR MANIFESTO G352 Reference Sire.

BCLR MANIFESTO G352

PB SM Bull ASA #3659574

SIRE: WS PROCLAMATION E202

MGS: GW PREDESTINED 701T

CE	BW	WW	YW	MCE	MILK	MWW	MARB	REA	SAPI	STI
8.1	3.2	108.5	158.9	4.4	25.7	79.9	0.63	0.91	163.7	106.7

Bulls to sire OPPORTUNITY!



LF740 Sells as Lot 34.

34 LF740 3/4 SM

Black Polled
Bull ASA #4311913 LF740 BD: 2/10/2023

WS PROCLAMATION E202 HOOK'S EASTWOOD 30C
BCLR MANIFESTO G352 OGRF740
ELLIOTT MISS 352 OGR C870

BW	10/22 WW	SALE WT	SC	ADG
91	902	1475	39.0	3.26

CE	BW	WW	YW	MCE	MILK	MWW	MB	REA	API	TI
10.1	2.2	96.1	142.8	5.3	22.7	70.7	0.41	0.92	138.0	90.8

33 LE488 PB SM

Black Polled
Bull ASA #4312007 LE488 BD: 2/16/2023

WS PROCLAMATION E202 BP533
BCLR MANIFESTO G352 OGRE488
ELLIOTT MISS 352 SVRX698

BW	10/22 WW	SALE WT	SC	ADG
92	1035	1515	40.0	4.01

CE	BW	WW	YW	MCE	MILK	MWW	MB	REA	API	TI
9.3	2.6	103.1	153.8	5.3	27.3	78.8	0.40	0.95	141.3	94.9

35 LB627 PB SM

Black Scurred
Bull ASA #4312004 LB627 BD: 2/10/2023

WS PROCLAMATION E202 HSF HIGH ROLLER 12T
BCLR MANIFESTO G352 OGRB627
ELLIOTT MISS 352 SVR2432

BW	10/22 WW	SALE WT	SC	ADG
95	962	1495	42.0	3.43

CE	BW	WW	YW	MCE	MILK	MWW	MB	REA	API	TI
9.4	2.5	90.3	129.5	5.2	30.1	75.2	0.40	0.79	132.8	87.1



36 LF828 3/4 SM

Black Polled
 Bull ASA #4311991 LF828 BD: 2/4/2023

WS PROCLAMATION E202 HOOK'S EASTWOOD 30C
 BCLR MANIFESTO G352 OGRF828
 ELLIOTT MISS 352 OGRY891

BW	10/22 WW	SALE WT	SC	ADG
91	822	1290	36.5	2.95

CE	BW	WW	YW	MCE	MILK	MWW	MB	REA	API	TI
10.3	2.3	88.9	133.6	5.8	25.7	70.1	0.49	0.70	136.6	88.2

37 LE558 3/4 SM

Black Polled
 Bull ASA #4311973 LE558 BD: 2/23/2023

WS PROCLAMATION E202 HOOK'S BALTIC 17B
 BCLR MANIFESTO G352 OGRE558
 ELLIOTT MISS 352 OGRY301

BW	10/22 WW	SALE WT	SC	ADG
90	812	1345	37.5	3.08

CE	BW	WW	YW	MCE	MILK	MWW	MB	REA	API	TI
10.3	2.2	91.0	142.0	5.3	19.9	65.4	0.49	0.72	144.4	89.6

38 LD233 3/4 SM

Black Polled
 Bull ASA #4311860 LD233 BD: 2/14/2023

WS PROCLAMATION E202 HOOKS ADMIRAL 33A
 BCLR MANIFESTO G352 OGRD233
 ELLIOTT MISS 352 OGRA281

BW	10/22 WW	SALE WT	SC	ADG
85	788	1255	38.5	3.10

CE	BW	WW	YW	MCE	MILK	MWW	MB	REA	API	TI
10.7	0.7	83.1	124.7	7.6	22.5	64.0	0.60	0.80	147.2	89.5

39 LE454 3/4 SM

Black Polled
 Bull ASA #4311969 LE454 BD: 2/9/2023

WS PROCLAMATION E202 HOOKS TRINITY 9T
 BCLR MANIFESTO G352 OGRE454
 ELLIOTT MISS 352 OGRC928

BW	10/22 WW	SALE WT	SC	ADG
85	818	1310	33.0	3.29

CE	BW	WW	YW	MCE	MILK	MWW	MB	REA	API	TI
11.1	0.7	86.8	130.3	6.1	20.5	63.8	0.54	0.77	148.0	90.0

40 LA357 3/4 SM

Black Polled
 Bull ASA #4312002 LA357 BD: 3/2/2023

WS PROCLAMATION E202 TFS BLACK ONYX 1442Y
 BCLR MANIFESTO G352 OGRA357
 ELLIOTT MISS 352 OGRY889

BW	10/22 WW	SALE WT	SC	ADG
91	790	1355	38.0	3.21

CE	BW	WW	YW	MCE	MILK	MWW	MB	REA	API	TI
9.4	2.3	85.3	126.1	5.2	23.1	65.6	0.34	0.63	136.9	81.9

41 LE487 7/8 SM

Black Polled
 Bull ASA #4311972 LE487 BD: 2/1/2023

WS PROCLAMATION E202 HOOK'S BALTIC 17B
 BCLR MANIFESTO G352 OGRE487
 ELLIOTT MISS 352 OGRZ408

BW	10/22 WW	SALE WT	SC	ADG
87	790	1465	35.5	3.19

CE	BW	WW	YW	MCE	MILK	MWW	MB	REA	API	TI
10.2	1.6	78.7	116.8	5.3	17.0	56.1	0.48	0.70	139.0	82.1

42 LE565 3/4 SM

Black Polled
 Bull ASA #4319700 LE565 BD: 2/11/2023

WS PROCLAMATION E202 GIBBS 0601X RAISINCAIN
 BCLR MANIFESTO G352 OGRE565
 ELLIOTT MISS 352 OGRB738

BW	10/22 WW	SALE WT	SC	ADG
87	908	1425	38.5	4.29

CE	BW	WW	YW	MCE	MILK	MWW	MB	REA	API	TI
9.6	2.1	91.3	136.9	5.4	25.0	70.5	0.43	0.89	134.1	89.0

DEER VALLEY GROWTH FUND

A fresh pedigree for our program that springs from the legendary Basin Payweight and a line of maternal cows that are considered Angus royalty. Capturing attention on paper and in the pasture, he is moderately framed with a powerful hip and rear leg, extra neck extension, a smooth shoulder, wide top and wide base. Capacity for gain readily apparent.



DEER VALLEY GROWTH FUND Reference Sire.

DEER VALLEY GROWTH FUND

PB AN Bull ASA #3681957

SIRE: BASIN PAYWEIGHT 1682

MGS: PLATTEMERE WEIGH UP K360

CE	BW	WW	YW	MCE	MILK	MWW	MARB	REA	\$API	\$TI
14.3	-0.8	111.3	191.8	11.4	30.3	84.4	0.56	0.54	147.8	96.7

Bulls to sire OPPORTUNITY!



LG103 Sells as Lot 44.

44 LG103 7/16 SM

Black Scurred
Bull ASA #4311919 LG103 BD: 2/4/2023

BASIN PAYWEIGHT 1682 OLF OTIS Y43
DEER VALLEY GROWTH FUND G103
DEER VALLEY RITA 36113 OGRE505

BW	10/22 WW	SALE WT	SC	ADG
87	958	1540	39.0	3.65

CE	BW	WW	YW	MCE	MILK	MWW	MB	REA	API	TI
14.6	0.0	99.8	162.0	10.7	27.4	76.5	0.23	0.72	140.5	91.0

43 LG346 1/2 SM

Black Polled
Bull ASA #4312000 LG346 BD: 2/24/2023

BASIN PAYWEIGHT 1682 TJ COWBOY UP 529B
DEER VALLEY GROWTH FUND G346
DEER VALLEY RITA 36113 OGRB707

BW	10/22 WW	SALE WT	SC	ADG
91	800	1310	38.5	3.23

CE	BW	WW	YW	MCE	MILK	MWW	MB	REA	API	TI
11.3	1.6	96.5	157.5	8.7	26.3	73.8	0.46	0.62	141.2	92.2

45 LF997 1/4 SM

Black Polled
Bull ASA #4311993 LF997 BD: 2/8/2023

BASIN PAYWEIGHT 1682 OGRDX203
DEER VALLEY GROWTH FUND OGRF997
DEER VALLEY RITA 36113 X101

BW	10/22 WW	SALE WT	SC	ADG
92	894	1430	40.0	2.97

CE	BW	WW	YW	MCE	MILK	MWW	MB	REA	API	TI
11.4	0.9	94.5	156.4	8.2	26.6	73.0	0.47	0.56	136.7	91.4



LB677 Sells as Lot 46.

46 LB677 1/4 SM

Black Polled
Bull ASA #4311963 LB677 BD: 2/10/2023

BASIN PAYWEIGHT 1682 OGRZU171
DEER VALLEY GROWTH FUND OGRB677
DEER VALLEY RITA 36113 OGR712

BW	10/22 WW	SALE WT	SC	ADG						
92	858	1425	38.0	3.71						
CE	BW	WW	YW	MCE	MILK	MWW	MB	REA	API	TI
11.3	0.9	88.0	151.5	8.2	26.3	69.5	0.51	0.54	141.4	89.1



LA459 Sells as Lot 47.

47 LA459 1/2 SM

Black Polled
Bull ASA #4311957 LA459 BD: 2/4/2023

BASIN PAYWEIGHT 1682 OGRYR611
DEER VALLEY GROWTH FUND OGRA459
DEER VALLEY RITA 36113 OGRW816

BW	10/22 WW	SALE WT	SC	ADG						
85	882	1340	38.0	2.95						
CE	BW	WW	YW	MCE	MILK	MWW	MB	REA	API	TI
11.5	0.6	89.7	144.3	8.4	31.1	75.2	0.43	0.63	140.0	88.7

48 LH399 7/16 SM

Black Polled
Bull ASA #4311977 LH399 BD: 1/19/2023

BASIN PAYWEIGHT 1682 GIBBS 0601X RAISINCAIN
DEER VALLEY GROWTH FUND H399
DEER VALLEY RITA 36113 OGRE487

BW	10/22 WW	SALE WT	SC	ADG						
80	888	1370	36.0	2.94						
CE	BW	WW	YW	MCE	MILK	MWW	MB	REA	API	TI
12.9	-0.1	93.2	153.5	8.9	24.2	70.0	0.41	0.75	143.9	91.2

49 LA41 1/4 SM

Black Polled
Bull ASA #4312001 LA41 BD: 2/10/2023

BASIN PAYWEIGHT 1682 SITZ MADISON 10477
DEER VALLEY GROWTH FUND OGRA41
DEER VALLEY RITA 36113 OGRN480

BW	10/22 WW	SALE WT	SC	ADG						
84	938	1515	37.0	3.50						
CE	BW	WW	YW	MCE	MILK	MWW	MB	REA	API	TI
12.6	-0.4	93.3	153.1	7.7	26.2	71.9	0.42	0.48	142.7	91.1



LB732 Sells as Lot 50.

50 LB732 3/8 SM

Black Polled
Bull ASA #4311964 LB732 BD: 2/8/2023

BASIN PAYWEIGHT 1682 GIBBS 0601X RAISINCAIN
DEER VALLEY GROWTH FUND OGRB732
DEER VALLEY RITA 36113 OGRX728

BW	10/22 WW	SALE WT	SC	ADG						
81	776	1310	37.0	3.35						
CE	BW	WW	YW	MCE	MILK	MWW	MB	REA	API	TI
13.2	-0.5	82.8	140.5	9.5	27.3	67.9	0.39	0.61	140.0	85.4

51 LG196 1/4 SMBlack Polled
Bull ASA #4319682 LG196

BD: 1/21/2023

BASIN PAYWEIGHT 1682
DEER VALLEY GROWTH FUND
DEER VALLEY RITA 36113V A R LEGEND 5019
G196
SVRX693

BW	10/22 WW	SALE WT	SC	ADG						
83	780	1390	38.0	3.73						
CE	BW	WW	YW	MCE	MILK	MWW	MB	REA	API	TI
13.3	0.0	93.3	161.3	10.9	25.3	70.7	0.52	0.53	151.4	93.6



ASA QUICK REFERENCE TO EPDS, INDEXES AND \$VALUES

EXPECTED PROGENY DIFFERENCES (EPDS): EPDs are the most accurate and effective tool available for comparing genetic levels. In using EPDs, the difference between two sires' EPDs represents the unit difference expected in the performance of their progeny. For example, if sires A and B have EPDs of +10 and -5, a 15-unit difference would be expected in their progeny (moving from -5 to +10 yields 15 units). Key to using EPDs is knowing in what units they are expressed. For example, if the above case referred to weaning weight EPDs, sire A would be expected to sire 15 pounds more weaning weight than sire B. If calving ease was the trait, sire A would be expected to sire 15 percent more unassisted births in first-calf heifers; in other words, if sire B sired 30 assists in a group of 100 heifers, we would expect sire A to require 15 assists. A percentile-ranking chart is required to determine where a bull's EPDs rank him relative to other bulls in the breed. For more detailed information about EPDs and \$ indexes, visit www.simmental.org.

Listed below are the units in which ASA EPDs are expressed:

ALL-PURPOSE INDEX (API): Dollars per cow exposed under an all-purpose-sire scenario.

BACK FAT (BF): Inches of carcass backfat at 475 days.

BIRTH WEIGHT (BW): Pounds of birth weight.

CALVING EASE (CE): Percent of unassisted births when used on heifers.

CARCASS WEIGHT (CW): Pounds of carcass weight at 475 days.

DOCILITY (DOC): Percent of offspring receiving a disposition score of 1 (docile).

MATERNAL CALVING EASE (MCE): Percent of unassisted births in first-calving daughters.

MILK (MLK): Pounds of weaning weight due to milk.

MARBLING (MARB): Carcass marbling score at 475 days.

MATERNAL WEANING WEIGHT (MWW): Pounds of weaning weight due to milk and growth.

RIBEYE AREA (REA): Square inches of carcass ribeye at 475 days.

TERMINAL INDEX (TI): Dollars per cow exposed under a terminal-sire scenario.

WEANING WEIGHT (WW): Pounds of weaning weight.

YEARLING WEIGHT (YW): Pounds of yearling weight.

YIELD GRADE (YG): Carcass yield grade score at 475 days.

\$ INDEXES: Though EPDs allow for the comparison of genetic levels for many economically important traits, they only provide pieces of the economic puzzle. This is where \$ indexes come in. Through well-conceived, rigorous mathematical computation, \$ indexes blend EPDs and economics to estimate an animal's overall impact on integrated commercial production. The same technology that led to the dramatic progress in swine, poultry and dairy genetics over the last several decades was used to develop the following \$ indexes:

ALL-PURPOSE INDEX (API): Evaluates sires for use on the entire cow herd (bred to both Angus first-calf heifers and mature cows) with the portion of their daughters required to maintain herd size retained and the remaining heifers and steers put on feed and sold grade and yield.

TERMINAL INDEX (TI): Evaluates sires for use on mature Angus cows with all offspring put on feed and sold grade and yield.

For more detailed information about EPDs and \$ indexes, visit: www.simmental.org

CDI MAJOR IMPACT 280H

High ranks for growth, elevated performance and product driven offspring. Some Purebred Simmental options here with massive rib eye and sound calving ease that would really compliment a set of traditional Angus cows.



CDI MAJOR IMPACT 280H Reference Sire.

CDI MAJOR IMPACT 280H

PB SM Bull ASA #3801544

SIRE: LCDR IMPACT 134F

MGS: CDI RIMROCK 325Z

CE	BW	WW	YW	MCE	MILK	MWW	MARB	REA	\$API	\$TI
9.2	3.4	94.1	142.5	6.4	22.7	69.7	0.04	1.50	122.6	84.4

Bulls to sire OPPORTUNITY!



LG102 Sells as Lot 53.

52 LF723 **PB SM**

Black Polled
Bull ASA #4311989 LF723 BD: 2/9/2023

LCDR IMPACT 134F OLF OTIS Y43
CDI MAJOR IMPACT 280H OGRF723
CDI MISS RIMROCK 55E OGRD199

BW	10/22 WW	SALE WT	SC	ADG
88	876	1390	41.5	3.21

CE	BW	WW	YW	MCE	MILK	MWW	MB	REA	API	TI
11.4	1.8	88.7	138.7	7.8	27.9	72.2	0.07	1.08	123.1	80.0

53 LG102 **PB SM**

Black Polled
Bull ASA #4311880 LG102 BD: 2/3/2023

LCDR IMPACT 134F OLF OTIS Y43
CDI MAJOR IMPACT 280H G102
CDI MISS RIMROCK 55E OGRE673

BW	10/22 WW	SALE WT	SC	ADG
96	850	1315	39.0	2.83

CE	BW	WW	YW	MCE	MILK	MWW	MB	REA	API	TI
10.7	2.9	88.1	134.9	7.0	21.7	65.6	-0.04	1.05	108.1	74.8

54 LD249 PB SM

Black Polled
Bull ASA #4268625 LD249 BD: 2/19/2023

LCDR IMPACT 134F OGRBX399
CDI MAJOR IMPACT 280H OGRD249
CDI MISS RIMROCK 55E OGRZ442

BW	10/22 WW	SALE WT	SC	ADG						
80	890	1225	39.5	2.88						
CE	BW	WW	YW	MCE	MILK	MWW	MB	REA	API	TI
10.6	1.8	86.1	130.5	7.2	27.1	70.1	0.15	1.23	121.7	80.4



LD249 Sells as Lot 54.

55 LG124 PB SM

Black Polled
Bull ASA #4311916 LG124 BD: 2/4/2023

LCDR IMPACT 134F OLF OTIS Y43
CDI MAJOR IMPACT 280H G124
CDI MISS RIMROCK 55E OGRE571

BW	10/22 WW	SALE WT	SC	ADG						
81	802	1310	41.0	3.12						
CE	BW	WW	YW	MCE	MILK	MWW	MB	REA	API	TI
12.7	0.7	83.2	128.4	8.6	19.8	61.3	0.00	1.12	120.7	75.8

56 LB47 PB SM

Black Polled
Bull ASA #4311962 LB47 BD: 2/14/2023

LCDR IMPACT 134F SV NORTHWEST FIGURE
CDI MAJOR IMPACT 280H OGRB47
CDI MISS RIMROCK 55E SVRZ358

BW	10/22 WW	SALE WT	SC	ADG						
91	856	1300	36.0	2.34						
CE	BW	WW	YW	MCE	MILK	MWW	MB	REA	API	TI
10.2	2.3	82.3	121.8	6.5	21.3	62.3	0.20	1.01	136.4	81.8

57 LC857 3/4 SM

Black Polled
Bull ASA #4268624 LC857 BD: 2/28/2023

LCDR IMPACT 134F GW PREMIUM BEEF 021TS
CDI MAJOR IMPACT 280H OGRC857
CDI MISS RIMROCK 55E OGRA289

BW	10/22 WW	SALE WT	SC	ADG						
90	778	1285	38.0	2.94						
CE	BW	WW	YW	MCE	MILK	MWW	MB	REA	API	TI
10.4	1.4	74.7	113.8	5.9	21.6	58.9	0.20	1.00	117.5	74.1

58 LF785 3/4 SM

Black Polled
Bull ASA #4311990 LF785 BD: 2/7/2023

LCDR IMPACT 134F MR NLC ENTREPRENEUR 1227
CDI MAJOR IMPACT 280H OGRF785
CDI MISS RIMROCK 55E OGRB53

BW	10/22 WW	SALE WT	SC	ADG						
86	806	1285	38.0	2.69						
CE	BW	WW	YW	MCE	MILK	MWW	MB	REA	API	TI
9.6	1.7	77.9	118.4	7.1	23.8	62.8	0.23	0.90	119.6	76.3



FF CONCLUSION F83

Chase at Universal Semen Sales keeps an eye out for our style of Angus Bulls to use in building Half Bloods. He recommended this rugged, powerfully shaped young herd builder prospect out of Jeff Fleisch's program and we're so glad we tried him out. We love his individual performance scores, we love that he is Montana made, and we love how balanced his carcass merit turned out in the matings.



FF CONCLUSION F83 Reference Sire.

FF CONCLUSION F83

PB AN Bull ASA #4301944

SIRE: BUSHES EASY DECISION 98

MGS: FF STIMULANT Y40

CE	BW	WW	YW	MCE	MILK	MWW	MARB	REA	\$API	\$TI
4.8	2.6	100.3	171.4	4.2	28.5	78.5	0.80	0.77	129.5	91.0

Bulls to sire OPPORTUNITY!



59 LF983 1/4 SM

Black Polled
Bull ASA #4311992 LF983 BD: 2/8/2023

BUSHES EASY DECISION 98 OGRDX203
FF CONCLUSION F83 F983
JF ERISKAY B80 OGRY621

BW	10/22 WW	SALE WT	SC	ADG
94	980	1595	39.0	3.45

CE	BW	WW	YW	MCE	MILK	MWW	MB	REA	API	TI
6.9	3.4	99.8	167.8	5.1	29.6	80.9	0.50	0.85	132.9	93.0

60 LA496 3/8 SM

Black Polled
Bull ASA #4311958 LA496 BD: 2/13/2023

BUSHES EASY DECISION 98 OGRYR611
FF CONCLUSION F83 OGRA496
JF ERISKAY B80 OGRW858

BW	10/22 WW	SALE WT	SC	ADG
91	968	1525	38.0	3.60

CE	BW	WW	YW	MCE	MILK	MWW	MB	REA	API	TI
7.6	2.3	92.7	149.7	5.3	32.2	79.9	0.62	0.76	138.4	93.2

61 LG221 1/4 SM

Black Polled
Bull ASA #4311996 LG221 BD: 2/14/2023

BUSHES EASY DECISION 98 GIBBS 0601X RAISINCAIN
FF CONCLUSION F83 G221
JF ERISKAY B80 B612

BW	10/22 WW	SALE WT	SC	ADG
81	900	1295	39.0	2.94

CE	BW	WW	YW	MCE	MILK	MWW	MB	REA	API	TI
8.8	1.4	92.6	156.2	6.0	30.2	77.9	0.67	0.85	146.8	96.3

62 LG118 3/8 SM

Black Polled
Bull ASA #4311928 LG118 BD: 2/4/2023

BUSHES EASY DECISION 98 OLF OTIS Y43
FF CONCLUSION F83 G118
JF ERISKAY B80 OGRE451

BW	10/22 WW	SALE WT	SC	ADG						
95	906	1395	40.0	3.22						
CE	BW	WW	YW	MCE	MILK	MWW	MB	REA	API	TI
8.8	2.5	96.1	161.4	6.6	25.3	74.6	0.45	0.79	136.5	90.9

63 LE460 1/4 SM

Black Polled
Bull ASA #4311970 LE460 BD: 2/8/2023

BUSHES EASY DECISION 98 CONNEALY CONSENSUS
FF CONCLUSION F83 OGRE460
JF ERISKAY B80 C880

BW	10/22 WW	SALE WT	SC	ADG						
86	844	1410	36.5	3.90						
CE	BW	WW	YW	MCE	MILK	MWW	MB	REA	API	TI
8.5	1.2	85.4	146.1	5.1	24.7	69.0	0.58	0.61	139.4	88.7

64 LG337 1/4 SM

Black Polled
Bull ASA #4311998 LG337 BD: 2/8/2023

BUSHES EASY DECISION 98 OGRDX203
FF CONCLUSION F83 G337
JF ERISKAY B80 OGRA820

BW	10/22 WW	SALE WT	SC	ADG						
86	782	1345	39.0	3.83						
CE	BW	WW	YW	MCE	MILK	MWW	MB	REA	API	TI
7.1	2.0	84.5	142.3	4.9	26.6	70.1	0.52	0.71	131.4	85.7



LG337 Sells as Lot 64.

65 LF717 1/2 SM

Black Polled
Bull ASA #4311988 LF717 BD: 2/8/2023

BUSHES EASY DECISION 98 WS ALL ABOARD B80
FF CONCLUSION F83 OGRF717
JF ERISKAY B80 OGRD198

BW	10/22 WW	SALE WT	SC	ADG						
83	800	1325	38.5	2.65						
CE	BW	WW	YW	MCE	MILK	MWW	MB	REA	API	TI
8.7	0.4	80.1	134.2	6.4	22.2	63.5	0.55	0.83	127.5	86.1



66 LD300 1/4 SM

Black Polled
Bull ASA #4312006 LD300 BD: 2/9/2023

BUSHES EASY DECISION 98 W/C UNITED 956Y
FF CONCLUSION F83 OGRD300
JF ERISKAY B80 SVR S298

BW	10/22 WW	SALE WT	SC	ADG						
92	976	1585	39.0	3.05						
CE	BW	WW	YW	MCE	MILK	MWW	MB	REA	API	TI
7.8	2.0	93.2	151.2	6.3	24.3	72.2	0.51	0.66	135.1	89.9



LD300 Sells as Lot 66.



CDI TRUSTEE 387F Sire of Lots 67-71.

67 LG158 3/4 SM

Black Polled
Bull ASA #4311995 LG158 BD: 2/16/2023

CDI REVIVAL 370D GIBBS 0601X RAISINCAIN
CDI TRUSTEE 387F G158
CDI MISS HOMETOWN 163C OGRD377

BW	10/22 WW	SALE WT	SC	ADG						
80	890	1445	38.0	3.54						
CE	BW	WW	YW	MCE	MILK	MWW	MB	REA	API	TI
11.6	1.2	93.1	142.8	5.4	25.8	71.7	0.31	1.21	135.1	89.7



68 LA506 PB SM

Black Scurred
Bull ASA #4311959 LA506 BD: 2/14/2023

CDI REVIVAL 370D TRIPLE C SINGLETARY S3H
CDI TRUSTEE 387F OGRA506
CDI MISS HOMETOWN 163C OGRW829

BW	10/22 WW	SALE WT	SC	ADG						
81	852	1230	39.5	2.77						
CE	BW	WW	YW	MCE	MILK	MWW	MB	REA	API	TI
11.5	1.0	80.5	122.0	6.3	26.0	66.2	0.30	1.13	130.2	81.8

69 LE621 7/8 SM

Black Polled
Bull ASA #4311987 LE621 BD: 2/10/2023

CDI REVIVAL 370D HOOK'S BALTIC 17B
CDI TRUSTEE 387F OGRE621
CDI MISS HOMETOWN 163C OGRY891

BW	10/22 WW	SALE WT	SC	ADG						
85	812	1255	39.5	2.99						
CE	BW	WW	YW	MCE	MILK	MWW	MB	REA	API	TI
12.2	1.3	80.7	128.8	4.5	20.4	60.6	0.31	0.97	131.8	81.5

70 LH454 3/4 SM

Black Polled
Bull ASA #4311981 LH454 BD: 1/21/2023

CDI REVIVAL 370D CCR 707 COWBOY 6055B
CDI TRUSTEE 387F H454
CDI MISS HOMETOWN 163C OGRE466

BW	10/22 WW	SALE WT	SC	ADG						
87	796	1265	37.5	2.87						
CE	BW	WW	YW	MCE	MILK	MWW	MB	REA	API	TI
11.8	1.4	80.4	124.9	4.9	20.2	60.4	0.33	0.97	134.0	81.4



LH346 Sells as Lot 71.

71 LH346 7/8 SM

Red Polled
Bull ASA #4311976 LH346 BD: 2/7/2023

CDI REVIVAL 370D FC892
CDI TRUSTEE 387F H346
CDI MISS HOMETOWN 163C OGRZ985

BW	10/22 WW	SALE WT	SC	ADG						
90	834	1395	39.0	3.68						
CE	BW	WW	YW	MCE	MILK	MWW	MB	REA	API	TI
10.9	2.9	88.5	137.2	3.6	22.2	66.3	0.23	1.16	124.9	82.5

72 LF737 PB SM

Red Polled
Bull ASA #4311886 LF737 BD: 2/8/2023

ERIXON BITTEN 203A OLF OTIS Y43
SAS COPPERHEAD G354 OGRF737
SAS MISS ARAPHAOE B354 OGRC895

BW	10/22 WW	SALE WT	SC	ADG						
87	952	1435	41.0	2.86						
CE	BW	WW	YW	MCE	MILK	MWW	MB	REA	API	TI
7.5	2.1	94.4	137.0	3.6	24.0	71.1	0.11	0.76	129.4	86.7



LF737 Sells as Lot 72.

73 LZ959 PB SM

Red Polled
Bull ASA #4311986 LZ959 BD: 2/11/2023

ERIXON BITTEN 203A CDI TRUMP FORCE 156W
SAS COPPERHEAD G354 OGRZ959
SAS MISS ARAPHAOE B354 OGRW830

BW	10/22 WW	SALE WT	SC	ADG						
96	840	1385	39.0	3.41						
CE	BW	WW	YW	MCE	MILK	MWW	MB	REA	API	TI
4.4	3.8	94.1	136.0	1.7	22.4	69.4	0.18	1.06	122.3	86.0



SAS COPPERHEAD G354 Sire of Lots 72-76.

74 LE636 PB SM

Red Polled
Bull ASA #4312009 LE636 BD: 3/1/2023

ERIXON BITTEN 203A WS ZENITH Z55
SAS COPPERHEAD G354 OGRE636
SAS MISS ARAPHAOE B354 SVR S687

BW	10/22 WW	SALE WT	SC	ADG						
90	808	1245	36.0	3.03						
CE	BW	WW	YW	MCE	MILK	MWW	MB	REA	API	TI
5.5	2.9	88.3	124.5	2.1	20.2	64.3	0.22	0.87	121.2	79.7

75 LD293 PB SM

Red Polled
Bull ASA #4312005 LD293 BD: 2/24/2023

ERIXON BITTEN 203A CNS DREAM ON L186
SAS COPPERHEAD G354 OGRD293
SAS MISS ARAPHAOE B354 SVRZ539

BW	10/22 WW	SALE WT	SC	ADG						
95	856	1505	38.5	3.59						
CE	BW	WW	YW	MCE	MILK	MWW	MB	REA	API	TI
4.9	3.3	88.9	122.6	1.9	21.8	66.1	0.20	0.86	115.5	79.0

76 LA600 3/4 SM

Red Polled
Bull ASA #4311961 LA600 BD: 2/28/2023

ERIXON BITTEN 203A BECKTON EPIC D404
SAS COPPERHEAD G354 OGRA600
SAS MISS ARAPHAOE B354 OGRY626

BW	10/22 WW	SALE WT	SC	ADG						
91	812	1370	36.5	3.75						
CE	BW	WW	YW	MCE	MILK	MWW	MB	REA	API	TI
5.5	2.6	86.3	125.0	3.2	20.5	63.6	0.13	0.60	111.1	76.1



LA600 Sells as Lot 76.



LF752 Sells as Lot 77.

77 LF752 1/2 SM

Red Polled
Bull ASA #4268616 LF752 BD: 1/24/2023

BIEBER SPARTACUS A193 HSR RED MAGNUM C708
BIEBER GLADIATOR C386 OGRF752
BIEBER LAURA 158W OGRF961

BW	10/22 WW	SALE WT	SC	ADG						
88	810	1265	37.0	3.01						
CE	BW	WW	YW	MCE	MILK	MWW	MB	REA	API	TI
14.6	-1.9	74.4	120.9	7.8	22.8	59.9	0.49	0.47	134.0	84.4

78 LH693 3/4 SM

Red Polled
Bull ASA #4268665 LH693 BD: 1/13/2023

GW REDESTINED 642X BIEBER GLADIATOR C386
CDI HOMETOWN 246A TAYLOR H693
CDI MS TRUMP 86U OGRF736

BW	10/22 WW	SALE WT	SC	ADG						
89	972	1495	39.0	3.67						
CE	BW	WW	YW	MCE	MILK	MWW	MB	REA	API	TI
8.7	1.7	99.5	155.2	3.0	26.1	75.8	0.46	1.12	136.1	95.8

79 LC467 PB SM

Red Polled
Bull ASA #4268292 LC467 BD: 2/6/2023

GW REDESTINED 642X OLF OTIS Y43
CDI HOMETOWN 246A TAYLORC467
CDI MS TRUMP 86U TAYLORA417

BW	10/22 WW	SALE WT	SC	ADG						
98	868	1400	38.0	4.06						
CE	BW	WW	YW	MCE	MILK	MWW	MB	REA	API	TI
8.8	2.8	91.0	140.7	4.0	23.3	68.7	0.20	1.13	137.4	87.2



LF593 Sells as Lot 80.

80 LF593 3/4 SM

Red Polled
Bull ASA #4268612 LF593 BD: 2/3/2023

DKSR GLACIER Z563 BROWN 3K STAKEHOLDER X7870
HSR RED MAGNUM C708 TAYLORF593
HSR MS BEEF MAKER X501 TAYLORZ383

BW	10/22 WW	SALE WT	SC	ADG						
98	1075	1580	36.5	3.58						
CE	BW	WW	YW	MCE	MILK	MWW	MB	REA	API	TI
13.3	1.8	107.4	165.8	7.6	21.4	75.0	0.27	0.90	139.1	95.4



LJ793 Sells as Lot 81.

81 LJ793 5/8 SM

Red Polled
Bull ASA #4268678 LJ793 BD: 2/3/2023

DKSR GLACIER Z563 BIEBER GLADIATOR C386
HSR RED MAGNUM C708 TAYLOR J793
HSR MS BEEF MAKER X501 TAYLORA421

BW	10/22 WW	SALE WT	SC	ADG						
84	830	1290	34.0	3.57						
CE	BW	WW	YW	MCE	MILK	MWW	MB	REA	API	TI
13.4	-0.5	84.5	133.6	7.3	22.1	64.3	0.43	0.64	138.1	88.4

82 LC883 1/2 SM

Red Polled
Bull ASA #4311967 LC883 BD: 1/10/2023

CDI TRUSTEE 387F BECKTON EPIC R397 K
JE463 OGRE463 OGR883 OGRA590

BW	10/22 WW	SALE WT	SC	ADG						
90	1105	1550	39.5	3.27						
CE	BW	WW	YW	MCE	MILK	MWW	MB	REA	API	TI
10.4	1.7	96.6	148.3	4.9	27.1	75.3	0.40	0.80	136.9	90.8

84 LE556 1/2 SM

Red Polled
Bull ASA #4268599 LE556 BD: 2/23/2023

FRITZ ANVIL 747C CDI MAVERICK 335B
FRITZ ANVIL 0259 TAYLORE556
FRITZ EMULOUS 398A TAYLORC478

BW	10/22 WW	SALE WT	SC	ADG						
88	840	1280	39.0	3.35						
CE	BW	WW	YW	MCE	MILK	MWW	MB	REA	API	TI
11.4	1.3	83.3	126.2	7.4	27.4	69.0	0.21	0.66	126.3	78.9

85 LH701 3/4 SM

Red Polled
Bull ASA #4268668 LH701 BD: 2/1/2023

WS ALL ABOARD B80 LEACHMAN CADILLAC L025A
KBHR ALL AMERICAN G104 TAYLOR H701
KBHR C078 TAYLORF584

BW	10/22 WW	SALE WT	SC	ADG						
93	830	1340	41.0	3.32						
CE	BW	WW	YW	MCE	MILK	MWW	MB	REA	API	TI
10.3	2.4	88.1	137.9	7.6	24.6	68.6	0.33	0.81	123.7	84.9



KBHR ALL AMERICAN G104 Sire of Lot 85.

87 LE481 5/8 SM

Black Polled
Bull ASA #4311971 LE481 BD: 3/2/2023

LFE MCDAVID 413C TJ COWBOY UP 529B
SPRINGCREEK TESLA 6E OGR481
SPRINGCREEK MISTRESS 17B OGRA364

BW	10/22 WW	SALE WT	SC	ADG						
95	896	1350	37.5	3.35						
CE	BW	WW	YW	MCE	MILK	MWW	MB	REA	API	TI
7.1	3.9	90.0	138.6	6.0	26.3	71.2	0.26	0.72	122.3	80.9



SPRINGCREEK TESLA 6E Sire of Lots 87-90.

88 LC867 1/2 SM

Black Polled
Bull ASA #4311966 LC867 BD: 2/8/2023

LFE MCDAVID 413C W/C UNITED 956Y
SPRINGCREEK TESLA 6E OGR867
SPRINGCREEK MISTRESS 17B OGR2401

BW	10/22 WW	SALE WT	SC	ADG						
95	862	1350	39.5	3.77						
CE	BW	WW	YW	MCE	MILK	MWW	MB	REA	API	TI
7.7	3.7	84.6	134.0	5.9	21.5	63.6	0.20	0.66	108.0	76.4

89 LC844 3/4 SM

Black Polled
Bull ASA #4311965 LC844 BD: 2/11/2023

LFE MCDAVID 413C WLE UNO MAS X549
SPRINGCREEK TESLA 6E OGR844
SPRINGCREEK MISTRESS 17B OGR2956

BW	10/22 WW	SALE WT	SC	ADG						
91	826	1305	37.0	2.78						
CE	BW	WW	YW	MCE	MILK	MWW	MB	REA	API	TI
7.8	3.1	78.0	119.7	4.8	21.6	60.5	0.28	0.71	114.2	75.4

OPEN GATE RANCH

90 LA281 5/8 SM

Black Polled
Bull ASA #4311943 LA281 BD: 2/24/2023

LFE MCDAVID 413C G A R PREDESTINED
SPRINGCREEK TESLA 6E OGRA281
SPRINGCREEK MISTRESS 17B SVR 691T

BW	10/22 WW	SALE WT	SC	ADG						
95	812	1260	37.5	2.95						
CE	BW	WW	YW	MCE	MILK	MWW	MB	REA	API	TI
7.2	3.8	75.4	118.4	6.2	26.4	64.1	0.41	0.69	119.3	76.2

92 LB436 1/2 SM

Black Homo Polled
Bull ASA #4268279 LB436 BD: 2/1/2023

CONNELY CONFIDENCE PLUS DIKEMANS SURE BET
STERLING BOND 007 TAYLORB436
MISS BLACKCAP ELLSTON J2 TAYLORW282

BW	10/22 WW	SALE WT	SC	ADG						
88	776	1255	37.0	3.49						
CE	BW	WW	YW	MCE	MILK	MWW	MB	REA	API	TI
10.9	0.4	75.1	120.9	6.6	19.0	57.8	0.60	0.74	137.5	83.7

94 LH408 3/4 SM

Black Polled
Bull ASA #4311979 LH408 BD: 1/27/2023

TRIPLE C SINGLETARY S3H HOOK'S CAPITALIST 37C
OGRBX399 H408
SVRX399 OGRE506

BW	10/22 WW	SALE WT	SC	ADG						
90	782	1280	38.5	3.41						
CE	BW	WW	YW	MCE	MILK	MWW	MB	REA	API	TI
11.6	1.3	71.1	112.4	7.7	24.6	59.9	0.50	0.82	139.7	80.3

95 LJ667 9/16 SM

Black Polled
Bull ASA #4311878 LJ667 BD: 2/28/2023

CONNELY CONSENSUS 7229 CDI TRUSTEE 387F
OGRDY602 J667
SVRY602 OGRA546

BW	10/22 WW	SALE WT	SC	ADG						
85	750	1235	39.5	2.74						
CE	BW	WW	YW	MCE	MILK	MWW	MB	REA	API	TI
12.0	1.6	71.5	106.2	5.6	23.5	59.4	0.32	0.58	124.8	73.4

96 LG100 1/2 SM

Black Polled
Bull ASA #4311994 LG100 BD: 2/5/2023

CONNELY CONSENSUS 7229 G100
OGRDY602 SVRY602
OGRA332

BW	10/22 WW	SALE WT	SC	ADG						
96	836	1395	40.0	3.72						
CE	BW	WW	YW	MCE	MILK	MWW	MB	REA	API	TI
11.1	1.9	67.8	102.0	5.8	19.9	53.9	0.31	0.42	122.9	70.6

97 LJ558 1/2 SM

Black Polled
Bull ASA #4311912 LJ558 BD: 3/1/2023

CONNELY CONSENSUS 7229 S A V TERRITORY 7225
OGRDY602 J558
SVRY602 OGRE497

BW	10/22 WW	SALE WT	SC	ADG						
90	790	1205	38.5	3.27						
CE	BW	WW	YW	MCE	MILK	MWW	MB	REA	API	TI
10.4	2.8	82.1	126.6	5.7	21.4	63.1	0.37	0.48	124.1	78.9



98 LG135 3/4 SM

Black Polled
Bull ASA #4319681 LG135 BD: 2/14/2023

CDI TRUSTEE 387F HOOK'S CAPITALIST 37C
JE463 G135
OGRE463 OGR917

BW	10/22 WW	SALE WT	SC	ADG						
81	832	1295	32.0	2.64						
CE	BW	WW	YW	MCE	MILK	MWW	MB	REA	API	TI
15.0	-1.2	67.3	105.2	7.7	20.3	53.8	0.50	0.64	143.8	80.5

99 KD75 1/2 SM

Black Polled
 Bull ASA #4210463 KD75 BD: 10/9/2022

S A V TERRITORY 7225 HL GAME PLAN R42X
 OPEN GATE HUDSON OGRD75
 OGR945 OGRY18

BW	10/22 WW	SALE WT	SC	ADG						
85	1290	1840	43.5	4.00						
CE	BW	WW	YW	MCE	MILK	MWW	MB	REA	API	TI
10.7	1.5	79.8	129.9	6.6	23.9	64.3	0.15	0.82	115.3	75.0



KD75 Sells as Lot 99.

100 KA590 3/8 SM

Hetero Black Polled
 Bull ASA #4210470 KA590 BD: 10/9/2022

S A V TERRITORY 7225 GW PREDESTINED 701T
 OPEN GATE HOBBS OGRA590
 OGRY891 SVR U295

BW	10/22 WW	SALE WT	SC	ADG						
86	1285	1920	43.0	4.70						
CE	BW	WW	YW	MCE	MILK	MWW	MB	REA	API	TI
10.5	1.0	84.3	135.5	6.1	24.3	67.3	0.55	0.38	133.4	86.9



KA590 Sells as Lot 100.



Please visit our website
opengateranch.com or
northernlivestockvideo.com
 to view videos of the
 bull offering.





101 L270 *7/8 SM Open Heifer*

Black Polled
 Cow ASA #4333077 L270 BD: 2/24/2023
 BW: 81 10/17 WW: 614

WS PROCLAMATION E202 TRIPLE C SINGLETARY S3H
 BCLR MANIFESTO G352 OGRB57
 ELLIOTT MISS 352 OGRT141

CE	BW	WW	YW	MCE	MILK	MWW	MB	REA	API	TI
9.1	2.6	91.4	133.7	6.0	26.5	72.1	0.54	0.90	148.6	94.3

102 L268 *3/4 SM Open Heifer*

Black Polled
 Cow ASA #4332951 L268 BD: 2/23/2023
 BW: 83 10/17 WW: 618

WS PROCLAMATION E202 W/C UNITED 956Y
 BCLR MANIFESTO G352 D258
 ELLIOTT MISS 352 SVRZ484

CE	BW	WW	YW	MCE	MILK	MWW	MB	REA	API	TI
9.6	2.3	92.9	142.8	5.8	22.3	68.6	0.49	0.75	141.0	90.5

103 L238 *3/4 SM Open Heifer*

Black Polled
 Cow ASA #4333076 L238 BD: 2/10/2023
 BW: 83 10/17 WW: 698

CDI REVIVAL 370D OGR SAGELAND
 CDI TRUSTEE 387F OGRA37
 CDI MISS HOMETOWN 163C HILLS T20 TENX 106GY

CE	BW	WW	YW	MCE	MILK	MWW	MB	REA	API	TI
11.1	2.2	85.0	132.4	4.8	23.3	65.8	0.29	1.01	132.4	84.5

104 L267 *3/4 SM Open Heifer*

Black Polled
 Cow ASA #4332978 L267 BD: 2/23/2023
 BW: 95 10/17 WW: 678

LFE MCDAVID 413C OLF OTIS Y43
 SPRINGCREEK TESLA 6E G123
 SPRINGCREEK MISTRESS 17B OGRE99

CE	BW	WW	YW	MCE	MILK	MWW	MB	REA	API	TI
8.8	3.8	96.0	151.8	7.3	24.5	72.4	0.07	0.97	125.9	84.6

105 L195 *1/2 SM Open Heifer*

Black Polled
 Cow ASA #4333078 L195 BD: 1/30/2023
 BW: 82 10/17 WW: 726

HOOK'S BLACK HAWK 50B S A V TERRITORY 722S
 HOOK'S EAGLE 6E H466
 HOOK'S CRYSTAL 1C OGR C870

CE	BW	WW	YW	MCE	MILK	MWW	MB	REA	API	TI
12.5	-0.7	91.7	145.7	4.8	20.6	66.6	0.49	1.00	147.8	93.1

106 L923T *1/2 SM Open Heifer*

Red Polled
 Cow ASA #4268592 L923T BD: 1/19/2023
 BW: 93 10/17 WW: 788

FRITZ ANVIL 747C OLF OTIS Y43
 FRITZ ANVIL 0259 TAYLORD522
 FRITZ EMULOUS 398A TAYLORZ392

CE	BW	WW	YW	MCE	MILK	MWW	MB	REA	API	TI
10.6	2.2	86.6	129.7	7.7	28.0	71.2	0.11	0.62	118.6	77.2

107 L971T *1/2 SM Open Heifer*

Red Polled
 Cow ASA #4268658 L971T BD: 2/26/2023
 BW: 96 10/17 WW: 714

CS182 BROWN BLW STATISTICIAN B5240
 TAYLOR JUDE G625T
 TAYLORC468 TAYLORC467

CE	BW	WW	YW	MCE	MILK	MWW	MB	REA	API	TI
9.8	2.9	89.9	141.9	5.9	25.7	70.5	0.14	0.72	123.8	80.2

108 L968T *1/2 SM Open Heifer*

Red Polled
 Cow ASA #4332979 L968T BD: 2/1/2023
 BW: 91 10/17 WW: 776

FRITZ ANVIL 747C WS BEEF MAKER R13
 FRITZ ANVIL 0259 SVRW592
 FRITZ EMULOUS 398A SPRING VALLEY P598

CE	BW	WW	YW	MCE	MILK	MWW	MB	REA	API	TI
10.8	1.1	79.4	118.3	8.1	24.2	63.8	0.29	0.66	127.9	79.2

110-126 COMMERCIAL SIMANGUS *Open Heifers*

13 months of age.

130-140 COMMERCIAL SIMANGUS *Open Heifers*

18 months of age.



MORE PER HEAD PERIOD



SimGenetics
PROFIT THROUGH SCIENCE
American Simmental Association

EFFECT OF SIRE BREED ON SALE PRICE OF BEEF STEER CALVES

Superior Livestock Auction, Summer 2020^a

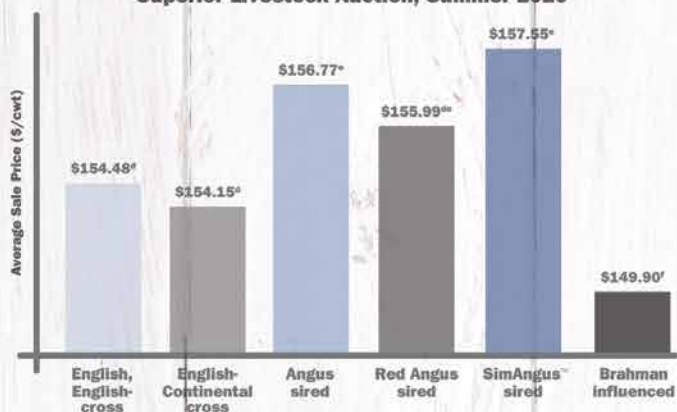

SimAngus™-sired steer calves sold through Superior Livestock Auction in summer 2020 earned **more at sale time** than all other calves.^b

It's no wonder the percentage of **SimAngus™** calves marketed through the industry's largest video auction has grown **eightfold** since 2010.

Want low-risk, high-potential calves with earning potential?

STAND STRONG SIMMENTAL

406-587-4531 • simmental.org

^a For lots of 50 head or more. ^b Kansas State University, December 2020, Superior Livestock Auction data analysis of 3,280 lots, 394,900 head of beef calves marketed during summer 2020. (P<.0001)
^c Lots that qualified for breed-related programs were excluded from the model due to potential confounding effects with sire breed analysis and, for many, few lots in the data.
^{d, e, f} Means without a common superscript differ (P<0.05) Lots of calves in breed-identified groups were sired by bulls from the respective breeds and out of dams with no Brahman influence.



Your only locally owned & operated livestock video auction with an extensive national buyer base.



Plan to use our **Northern Weekly Timed Online Auctions** late September through early June.

Call for details (866) 616-5035 or go to northernlivestockvideo.com

As we enter our 21st year of business, we invite you to market your cattle and sheep with us as one of the leading marketing firms in the nation. As a consignor or a buyer you will like our way of doing business.



2024 SALES

Early Summer Special	June 20-21
Summertime Classic	July 22-24
Early Fall Preview	August 19-20
Fall Premier Special	September 16

HOME OF THE
NORTHERN GOLD
PROGRAM

SALE COORDINATORS

Joe Goggins
(406) 861-5664

Ty Thompson
(406) 698-4783

Bill Cook
(406) 670-0689

OPEN GATE RANCH

121 8th Lane SW
Fairfield, MT 59436

Presorted
First Class
US Postage
PAID
SlateGroup

Open Gate Ranch

44th Annual Bull Sale



Friday, March 29, 2024

1:00 pm • Augusta, MT

At Broken O Land and Livestock

Simmental. SimAngus. BUILD BETTER BEEF.